



**Haringey** Council

---

## Licensing Sub Committee A

---

TUESDAY, 10TH APRIL, 2012 at 19:00 HRS - CIVIC CENTRE, HIGH ROAD, WOOD GREEN, N22 8LE.

**MEMBERS:** Councillors Mallett, Peacock (Chair) and Scott

### **AGENDA**

**1. APOLOGIES FOR ABSENCE**

**2. URGENT BUSINESS**

The Chair will consider the admission of any late items of urgent business. (Late items will be considered under the agenda item where they appear. New items will be dealt with at item below).

**3. DECLARATIONS OF INTEREST**

A member with a personal interest in a matter who attends a meeting of the authority at which the matter is considered must disclose to that meeting the existence and nature of that interest at the commencement of that consideration, or when the interest becomes apparent.

A member with a personal interest in a matter also has a prejudicial interest in that matter if the interest is one which a member of the public with knowledge of the relevant facts would reasonably regard as so significant that it is likely to prejudice the member's judgement of the public interest **and** if this interest affects their financial position or the financial position of a person or body as described in paragraph 8 of the Code of Conduct **and/or** if it relates to the determining of any approval, consent, licence, permission or registration in relation to them or any person or body described in paragraph 8 of the Code of Conduct.

**4. SUMMARY OF PROCEDURE (PAGES 1 - 2)**

The Chair will explain the procedure that the Committee will follow for the hearing considered under the Licensing Act 2003 or Gambling Act 2005. A copy of the procedure is attached.

**5. 369 GREEN LANES, LONDON N4 1DY (PAGES 3 - 34)**

To consider an application for a new Premises Licence to allow the Supply of Alcohol and the Provision of Regulated Entertainment.

**6. TRADITIONAL TURKISH COFFEE HOUSE, REAR OF 63 GRAND PARADE, GREEN LANES, LONDON N4 1AF (PAGES 35 - 108)**

To consider an application for a new Premises Licence to allow the Supply of Alcohol and the Provision of Late Night Refreshment.

**7. ITEMS OF URGENT BUSINESS**

To consider any new items of admitted under item 2 above.

David McNulty  
Head of Local Democracy  
and Member Services  
Level 5  
River Park House  
225 High Road  
Wood Green  
London N22 8HQ

Helen Chapman X2615  
Principal Committee Coordinator  
Level 5  
River Park House  
225 High Road  
Wood Green  
London N22 8HQ

Tel: 020 8489 2615  
Email: Helen.Chapman.X2615

Tuesday, 27 March 2012

<b>LICENSING SUB-COMMITTEE HEARINGS PROCEDURE SUMMARY</b>	
<b>INTRODUCTION</b>	
1.	The Chair introduces himself and invites other Members, Council officers, Police, Applicant and Objectors to do the same.
2.	The Chair invites Members to disclose any prior contacts (before the hearing) with the parties or representations received by them
3.	The Chair explains the procedure to be followed by reference to this summary which will be distributed.
<b>NON-ATTENDANCE BY PARTY OR PARTIES</b>	
4.	If one or both of the parties fails to attend, the Chair decides whether to:
	(i) grant an adjournment to another date, or
	(ii) proceed in the absence of the non-attending party.
	Normally, an absent party will be given one further chance to attend.
<b>TOPIC HEADINGS</b>	
5.	The Chair suggests the "topic headings" for the hearing. In the case of the majority of applications for variation of hours, or other terms and conditions, the main topic is:  <b>Whether the extensions of hours etc. applied for would conflict with the four licensing objectives i.e.</b>
	(i) the prevention of crime and disorder,
	(ii) public safety,
	(iii) the prevention of public nuisance, and
	(iv) the protection of children from harm.
6.	The Chair invites comments from the parties on the suggested topic headings and decides whether to confirm or vary them.
<b>WITNESSES</b>	
7.	The Chair asks whether there are any requests by a party to call a witness and decides any such request.
8.	Only if a witness is to be called, the Chair then asks if there is a request by an opposing party to "cross-examine" the witness. The Chair then decides any such request.
<b>DOCUMENTARY EVIDENCE</b>	
9.	The Chair asks whether there are any requests by any party to introduce late documentary evidence.
10.	If so, the Chair will ask the other party if they object to the admission of the late documents.
11.	If the other party do object to the admission of documents which have only been produced by the first party at the hearing, then the documents shall not be admitted.

12.	If the other party object to documents produced late but before the hearing, the following criteria shall be taken into account when the Chair decides whether or not to admit the late documents:	
(i)	What is the reason for the documents being late?	
(ii)	Will the other party be unfairly taken by surprise by the late documents?	
(iii)	Will the party seeking to admit late documents be put at a major disadvantage if admission of the documents is refused?	
(iv)	Is the late evidence really important?	
(v)	Would it be better and fairer to adjourn to a later date?	
<b>THE LICENSING OFFICER'S INTRODUCTION</b>		
13.	The Licensing Officer introduces the report explaining, for example, the existing hours, the hours applied for and the comments of the other Council Services or outside official bodies. This should be as "neutral" as possible between the parties.	
14.	The Licensing Officer can be questioned by Members and then by the parties.	
<b>THE HEARING</b>		
15.	This takes the form of a discussion led by the Chair. The Chair can vary the order as appropriate but it should include:	
(i)	an introduction by the Objectors' main representative	
(ii)	an introduction by the Applicant or representative	
(iii)	questions put by Members to the Objectors	
(iv)	questions put by Members to the Applicant	
(v)	questions put by the Objectors to the Applicant	
(vi)	questions put by the Applicant to the Objectors	
<b>CLOSING ADRESSES</b>		
16.	The Chair asks each party how much time is needed for their closing address, if they need to make one.	
17.	Generally, the Objectors make their closing address before the Applicant who has the right to the final closing address.	
<b>THE DECISION</b>		
18.	Members retire with the Committee Clerk and legal representative to consider their decision including the imposition of conditions.	
19.	The decision is put in writing and read out in public by the Committee Clerk once Members have returned to the meeting.	

**Licensing Act 2003 Sub-Committee on 10<sup>th</sup> April 2012**

**Report title: Application for a New Premises Licence at 369 GREEN LANES, LONDON N4 1DY**

**Report of: The Lead Officer Licensing**

**Ward(s) affected Harringay**

**1. Purpose**

To consider an application by Mehmet Ickan and Rakkas Ltd to allow Supply of Alcohol & The Provision of Regulated Entertainment.

**2. Recommendations**

- 2.1 (a) Grant the application as asked  
 (b) Modify the conditions of the licence, by altering or omitting or adding to them  
 (c) Reject the whole or part of the application

The Committee is asked to note that it may not modify the conditions or reject the whole or part of the application unless it is necessary to promote the licensing objectives.

Report authorised by: Joan Hancox

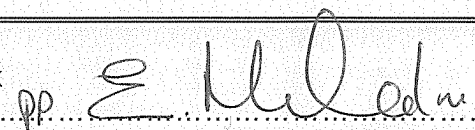

Head of Neighbourhood Services

**Contact Officer: Ms Daliah Barrett -Williams**

**Telephone: 020 8489 8232**

**3. Executive summary**

For consideration by Licensing Sub Committee under Licensing Act 2003 for a Premises licence with variation to the existing conditions

**4. Access to information:**

Local Government (Access to Information) Act 1985

Background Papers

The following Background Papers are used in the preparation of this Report:

File: 369 Green Lanes

The Background Papers are located at Enforcement Service, Technopark, Ashley Road, Tottenham N17

This page is intentionally left blank

## 5. REPORT

### Background

5.1 An application for a new Premises Licence, by Mehmet Ickan and Rakkas Ltd in respect of 369 Green Lanes under the Licensing Act 2003.

5.2 Details of the application being sought under the Premises Licence-APP 1

#### Regulated Entertainment: Live Music

Monday to Saturday 1800 to 2300 hours

#### Supply of Alcohol

Sunday to Thursday 1100 to 2300 hours

Friday & Saturday 1100 to 0200 hours

For consumption ON the premises

#### Hours open to the public

Sunday to Thursday 0600 to 2330 hours

Friday & Saturday 0600 to 0230 hours

### General-all four licensing objectives

As below;

Also all Health and Safety steps will be taken and training will be given to staff including food and hygiene.

### 5.3 Crime and Disorder

CCTV

Security men

### 5.4 Public Safety

CCTV

Emergency Exit signs

Fire alarm

Smoke detector

Safety lights

### 5.5 Public Nuisance

CCTV

Security men

Sound proofing

**5.6 Child Protection**

Designated area at front away from smoke area at back.

**6. RELEVANT REPRESENTATIONS (CONSULTATION)**

**Responsible authorities:**

**6.1 Comments of Metropolitan Police**

Have made representation. APP 2

**6.2 Comments of Regulatory Services:**

**Environmental Health**

Have made representation regarding this application. APP 3

**Trading Standards**

Have made no representation to this application

**6.3 London Fire and Civil Defence Authority**

Have made no representation to this application

**6.4 Planning Services**

Comments made regarding this application. APP 4

**6.5 Comments of Child Protection Agency or Nominee**

No representation made on this matter

**7.0 Interested Parties**

No letters of representation has been received against this application.

**8.0 Financial Comments**

The fee which would be applicable for this application was **£190.00**.  
The Panel is asked to note that the operating schedule does not give any wording as to the conditions proposed by the applicant. Members are asked to ensure that enforceable conditions are imposed from the wording offered by the applicant.

## APPENDIX 1-- APPLICATION

2140.  
K51028  
26/01/12

# Application for a premises licence to be granted under the Licensing Act 2003

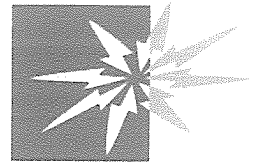

Haringey Council

(1)

Reference number:

## PLEASE READ THE FOLLOWING INSTRUCTIONS FIRST

Before completing this form please read the guidance notes at the end of the form.  
If you are completing this form by hand please write legibly in block capitals. In all cases ensure that your answers are inside the boxes and written in black ink. Use additional sheets if necessary.  
You may wish to keep a copy of the completed form for your records

(2) I/We

apply for a premises licence under section 17 the Licensing Act 2003 for the premises described in Part 1 below (the premises) and I/we are making this application to you as the relevant licensing authority in accordance with section 12 of the Licensing Act 2003

### Part 1 - Premises details

Postal address of premises or, if none, Ordnance Survey map reference or description  
369 GREEN LANES  
HARINGEY

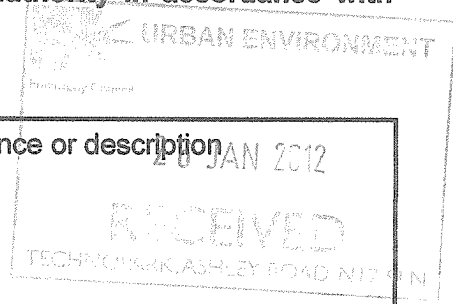

Post town LONDON Postcode N4 1DY

Telephone number at premises(if any) 0203 4892515

Non-domestic rateable value of premises £ 6,700

### Part 2 - Applicant details

Please state whether you are applying for a premises licence as

- a) an individual or individuals\*  please complete section (A)
- b) a person other than an individual\*
  - i. as a limited company  please complete section (B)
  - ii. as a partnership  please complete section (B)
  - iii. as an unincorporated association; or  please complete section (B)
  - iv. other (for example a statutory corporation)  please complete section (B)

Please tick  yes

(1) Insert name and address of relevant licensing authority and its reference number (optional)  
(2) Insert name(s) of applicant

- c) a recognised club  please complete section (B)
- d) a charity  please complete section (B)
- e) the proprietor of an educational establishment  please complete section (B)
- f) a health service body  please complete section (B)
- g) a person who is registered under Part 2 of the Care Standards Act 2000 (c14) in respect of an independent hospital  please complete section (B)
- h) the chief officer of police of a police force in England and Wales  please complete section (B)

\* If you are applying as a person described in (a) or (b) please confirm:

- I am carrying on or proposing to carry on a business which involves the use of the premises for licensable activities; or Please tick  yes
- I am making the application pursuant to
  - a statutory function; or
  - a function discharged by virtue of Her Majesty's prerogative

(A) INDIVIDUAL APPLICANTS (fill in as applicable)

Mr  Mrs  Miss  Ms  Other title (for example, Rev)

Surname  First names

I am 18 years old or over  Please tick  yes Date of birth 

Day	Month	Year
1	4	021965

Current postal address if different from premises address

~~XXXXXXXXXX ROAD~~ 369 GREEN LANES  
~~XXXXXXXXXX ROAD~~ LONDON  
~~XXXXXXXXXX~~ N4 1DY

Post town  Postcode

Daytime contact telephone number

E-mail address (optional)

SECOND INDIVIDUAL APPLICANT (if applicable)

Mr  Mrs  Miss  Ms  Other title  (for example, Rev)

Surname  First names

I am 18 years old or over  Please tick  yes Date of birth 

Day	Month	Year
<input type="text"/>	<input type="text"/>	<input type="text"/>

Current postal address if different from premises address

Post town  Postcode

Daytime contact telephone number

E-mail address (optional)

(B) OTHER APPLICANTS

Please provide name and registered address of applicant in full. Where appropriate please give any registered number. In the case of a partnership or other joint venture (other than a body corporate), please give the name and address of each party concerned.

Name	RAKKAS LTD
Address	369 GREEN LANES HARINGEY LONDON N4 1DY
Registered number (where applicable)	7856459
Description of applicant (for example partnership, company, unincorporated association etc.)	DIRECTOR - MEHMET ICKAN
Telephone number (if any)	0203 4892515
E-mail address (optional)	

Part 3 - Operating Schedule

When do you want the premises licences to start?

Day	Month	Year
01	02	2012

If you wish the licence to be valid only for a limited period, when do you want it to end?

Day	Month	Year

Please give a general description of the premises (please read guidance note 1)

GENERAL LICENSED RESTAURANT  
GARDEN  
WITH OUTDOOR SPACE FOR SHISHA

If 5,000 or more people are expected to attend the premises at any one time, please state the number expected to attend

--

What licensable activities do you intend to carry on from the premises?  
(Please see sections 1 and 14 of the Licensing Act 2003 and Schedule 1 and 2 to the Licensing Act 2003)

**Provision of regulated entertainment**

Please tick  yes

- a) plays (if ticking yes, fill in box A)
- b) films (if ticking yes, fill in box B)
- c) indoor sporting events (if ticking yes, fill in box C)
- d) boxing or wrestling entertainment (if ticking yes, fill in box D)
- e) live music (if ticking yes, fill in box E)
- f) recorded music (if ticking yes, fill in box F)
- g) performances of dance (if ticking yes, fill in box G)
- h) anything of a similar description to that falling within (e), (f) or (g) (if ticking yes, fill in box H)

**Provision of entertainment facilities for:**

- i) making music (if ticking yes, fill in box I)
- j) dancing (if ticking yes, fill in box J)
- k) entertainment of a similar description to that falling within (i) or (j) (if ticking yes, fill in box K)

**Provision of late night refreshment (if ticking yes, fill in box L)**

**Supply of alcohol (if ticking yes, fill in box M)**

**In all cases complete boxes N, O and P**

---

**A**

<b>Plays</b>			Will the performance of a play take place indoors or outdoors or both - please tick <input checked="" type="checkbox"/> (please read guidance note 2)  Indoors <input type="checkbox"/> Outdoors <input type="checkbox"/> Both <input type="checkbox"/>
Standard days and timings (please read guidance note 6)			
<b>Day</b>	<b>Start</b>	<b>Finish</b>	Please give further details here (please read guidance note 3)
Mon			
			State any seasonal variations for performing plays (please read guidance note 4)
Tue			
			Non-standard timings. Where you intend to use the premises for the performance of plays at different times from those listed in the column on the left, please list (please read guidance note 5)
Wed			
Thur			
Fri			
Sat			
Sun			

**B**

<b>Films</b>			Will the exhibition of films take place indoors or outdoors or both - please tick <input checked="" type="checkbox"/> (please read guidance note 2)  Indoors <input type="checkbox"/> Outdoors <input type="checkbox"/> Both <input type="checkbox"/>
Standard days and timings (please read guidance note 6)			
<b>Day</b>	<b>Start</b>	<b>Finish</b>	Please give further details here (please read guidance note 3)
Mon			
			State any seasonal variations for the exhibition of films (please read guidance note 4)
Tue			
			Non-standard timings. Where you intend to use the premises for the exhibition of films at different times from those listed in the column on the left, please list (please read guidance note 5)
Wed			
Thur			
Fri			
Sat			
Sun			

**C**

<b>Indoor sporting events</b> Standard days and timings (please read guidance note 6)			Please give further details here (please read guidance note 3)
<b>Day</b>	<b>Start</b>	<b>Finish</b>	
Mon			
Tue			State any seasonal variations for indoor sporting events (please read guidance note 4)
Wed			Non-standard timings. Where you intend to use the premises for indoor sporting events at different times from those listed in the column on the left, please list (please read guidance note 5)
Thur			
Fri			
Sat			
Sun			

**D**

<b>Boxing or wrestling entertainments</b> Standard days and timings (please read guidance note 6)			Will the boxing or wrestling entertainment take place indoors or outdoors or both - please tick <input checked="" type="checkbox"/> (please read guidance note 2)		
<b>Day</b>	<b>Start</b>	<b>Finish</b>	Indoors <input type="checkbox"/> Outdoors <input type="checkbox"/> Both <input type="checkbox"/>		
Mon			Please give further details here (please read guidance note 3)		
Tue			State any seasonal variations for boxing or wrestling entertainment (please read guidance note 4)		
Wed			Non-standard timings. Where you intend to use the premises for boxing or wrestling entertainment at different times from those listed in the column on the left, please list (please read guidance note 5)		
Thur					
Fri					
Sat					
Sun					

**E**

Live music			Will the performance of live music take place indoors or outdoors or both - please tick <input checked="" type="checkbox"/> (please read guidance note 2)
Day	Start	Finish	
Standard days and timings (please read guidance note 6)			Indoors <input checked="" type="checkbox"/> Outdoors <input type="checkbox"/> Both <input type="checkbox"/>
Mon	18.00	23.00	Please give further details here (please read guidance note 3)
Tue	18.00	23.00	
Wed	18.00	23.00	State any seasonal variations for the performance of live music (please read guidance note 4)
Thur	18.00	23.00	
Fri	18.00	23.00	Non-standard timings. Where you intend to use the premises for the performance of live music at different times from those listed in the column on the left, please list (please read guidance note 5)
Sat	18.00	23.00	
Sun	-	-	

**F**

Recorded music			Will the playing of recorded music take place indoors or outdoors or both - please tick <input checked="" type="checkbox"/> (please read guidance note 2)
Day	Start	Finish	
Standard days and timings (please read guidance note 6)			Indoors <input checked="" type="checkbox"/> Outdoors <input type="checkbox"/> Both <input type="checkbox"/>
Mon	00.00	23.00	Please give further details here (please read guidance note 3)
Tue	00.00	23.00	
Wed	00.00	23.00	State any seasonal variations for the playing of recorded music (please read guidance note 4)
Thur	00.00	23.00	
Fri	00.00	02.00	Non-standard timings. Where you intend to use the premises for the playing of recorded music entertainment at different times from those listed in the column on the left, please list (please read guidance note 5)
Sat	00.00	02.00	
Sun	10.00	23.00	

**G**

<b>Performances of dance</b> Standard days and timings (please read guidance note 6)			Will the performance of dance take place indoors or outdoors or both - please tick <input checked="" type="checkbox"/> (please read guidance note 2)
<b>Day</b>	<b>Start</b>	<b>Finish</b>	Indoors <input type="checkbox"/> Outdoors <input type="checkbox"/> Both <input type="checkbox"/>
Mon			Please give further details here (please read guidance note 3)
Tue			
Wed			State any seasonal variations for the performance of dance (please read guidance note 4)
Thur			
Fri			Non-standard timings. Where you intend to use the premises for the performance of dance entertainment at different times from those listed in the column on the left, please list (please read guidance note 5)
Sat			
Sun			

**H**

<b>Anything of a similar description to that falling within (e), (f) or (g)</b> Standard days and timings (please read guidance note 6)			Please give a description of the type of entertainment you will be providing
<b>Day</b>	<b>Start</b>	<b>Finish</b>	Will this entertainment take place indoors or outdoors or both - please tick <input checked="" type="checkbox"/> (please read guidance note 2)
Mon			Indoors <input type="checkbox"/> Outdoors <input type="checkbox"/> Both <input type="checkbox"/>
			Please give further details here (please read guidance note 3)
Tue			
Wed			
			State any seasonal variations for entertainment of a similar description to that falling within (e), (f) or (g) (please read guidance note 4)
Thur			
			Non-standard timings. Where you intend to use the premises for the entertainment of similar description to that falling within (e), (f) or (g) at different times from those listed in the column on the left, please list (please read guidance note 5)
Fri			
Sat			
Sun			

<b>Provision of facilities for making music</b>			Please give a description of the facilities for making music you will be providing
Standard days and timings (please read guidance note 6)			Will the facilities for making music be indoors or outdoors or both - please tick <input checked="" type="checkbox"/> (please read guidance note 2) Indoors <input type="checkbox"/> Outdoors <input type="checkbox"/> Both <input type="checkbox"/>
Day	Start	Finish	Please give further details here (please read guidance note 3)
Mon			
			State any seasonal variations for the provision of facilities for making music (please read guidance note 4)
Tue			
			Non-standard timings. Where you intend to use the premises for provision of facilities for making music at different times from those listed in the column on the left, please list (please read guidance note 5)
Wed			
Thur			
Fri			
Sat			
Sun			

**J**

<b>Provision of facilities for dancing</b>			Please give a description of the facilities for dancing you will be providing
Standard days and timings (please read guidance note 6)			Will the facilities for dancing be indoors or outdoors or both - please tick <input checked="" type="checkbox"/> (please read guidance note 2) Indoors <input type="checkbox"/> Outdoors <input type="checkbox"/> Both <input type="checkbox"/>
Day	Start	Finish	Please give further details here (please read guidance note 3)
Mon			
			State any seasonal variations for providing dancing facilities (please read guidance note 4)
Tue			
			Non-standard timings. Where you intend to use the premises for the provision of facilities for dancing entertainment at different times from those listed in the column of the left, please list (please read guidance note 5)
Wed			
Thur			
Fri			
Sat			
Sun			

**K**

<b>Provision of facilities for entertainment of a similar description to that falling within I or J</b>			Please give a description of the type of entertainment facility you will be providing
Standard days and timings (please read guidance note 6)			Will the entertainment facility be indoors or outdoors or both - please tick <input checked="" type="checkbox"/> (please read guidance note 2)
			Indoors <input type="checkbox"/> Outdoors <input type="checkbox"/> Both <input type="checkbox"/>
<b>Day</b>	<b>Start</b>	<b>Finish</b>	Please give further details here (please read guidance note 3)
Mon			
Tue			
Wed			State any seasonal variations for the provision of facilities for entertainment of a similar description to that falling within I or J (please read guidance note 4)
Thur			
Fri			Non-standard timings. Where you intend to use the premises for the provision of facilities for entertainment of a similar description to that falling within I or J at different times from those listed in the column on the left, please list (please read guidance note 5)
Sat			
Sun			

L

<b>Late night refreshment</b>			Will the provision of late night refreshment take place indoors or outdoors or both - please tick <input checked="" type="checkbox"/> (please read guidance note 2)  Indoors <input checked="" type="checkbox"/> Outdoors <input type="checkbox"/> Both <input type="checkbox"/>
Standard days and timings (please read guidance note 6)			
<b>Day</b>	<b>Start</b>	<b>Finish</b>	Please give further details here (please read guidance note 3)
Mon	06.00	23.00	
Tue	06.00	23.00	
Wed	06.00	23.00	State any seasonal variations for the provision of late night refreshment (please read guidance note 4)
Thur	06.00	23.00	
Fri	06.00	23.00	Non-standard timings. Where you intend to use the premises for the provision of late night refreshment at different times from those listed in the column on the left, please list (please read guidance note 5)
Sat	06.00	23.00	
Sun	06.00	23.00	

M

<b>Supply of alcohol</b>			Will the sale of alcohol be for consumption - please tick box <input checked="" type="checkbox"/> (please read guidance note 7)  On the premises <input checked="" type="checkbox"/> Off the premises <input type="checkbox"/> Both <input type="checkbox"/>
Standard days and timings (please read guidance note 6)			
<b>Day</b>	<b>Start</b>	<b>Finish</b>	State any seasonal variations for the supply of alcohol (please read guidance note 4)
Mon	11.00 am	23.00	
Tue	11.00	23.00	
Wed	11.00	23.00	
Thur	11.00	23.00	Non-standard timings. Where you intend to use the premises for the supply of alcohol at different times from those listed in the column on the left, please list (please read guidance note 5)
Fri	11.00	02.00	
Sat	11.00	02.00	
Sun	11.00	23.00	

State the name and details of the individual whom you wish to specify on the licence as premises supervisor

Name **MEHMET ICKAN**  
 Address **13 LEIGH COURT CLEVELAND ROAD**  
 Postcode **E18 2AG**  
 Personal Licence number (if known)  
 Issuing licensing authority (if known)

**N**

Please highlight any adult entertainment or services, activities, other entertainment or matters ancillary to the use of the premises that may give rise to concern in respect of children (please read guidance note 8)

THERE IS BACK GARDEN OUTDOOR SPACE WHICH WILL BE USED FOR SHISHA.

**O**

**Hours premises are open to the public**  
 Standard days and timings  
 (please read guidance note 6)

Day	Start	Finish
Mon	06.00	23.30
Tue	06.00	23.30
Wed	06.00	23.30
Thur	06.00	23.30
Fri	06.00	02.30
Sat	06.00	02.30
Sun	06.00	23.30

State any seasonal variations (please read guidance note 4)

PLEASE NOTE THAT GARDEN SECTION  
 OPEN FROM  
 WILL ~~BE~~ 07.00 AM TO 21.00  
 MON TO THURS & SUN  
 07.00 AM - 23.30  
~~BE~~ FRI - SAT.

Non-standard timings. Where you intend to use the premises to be open to the public at different times from those listed in the column on the left, please list (please read guidance note 5)

**P** Describe the steps you intend to take to promote the four licensing objectives:

a) General - all four licensing objectives (b, c, d, e) (please read guidance note 9)

AS BELOW;  
 ALSO ALL HEALTH & SAFETY STEPS WILL BE TAKEN &  
 TRAINING WILL BE GIVEN TO STAFF.  
 INCLUDING FOOD & HYGIENE.

b) The prevention of crime and disorder

CCTV  
 SECURITY MEN

c) Public safety

CCTV  
 EMERGENCY EXITS SIGNS  
 FIRE ALARM  
 SMOKE DETECTOR.  
 SAFETY LIGHTS

d) The prevention of public nuisance

CCTV,  
 SECURITY MEN  
 SOUND PROOFING

e) The protection of children from harm

DESIGNATED AREA AT FRONT AWAY FROM SMOKE AREA AT BACK

CHECKLIST:

Please tick ✓

- I have made or enclosed payment of the fee
- I have enclosed the plan of the premises
- I have sent copies of this application and the plan to responsible authorities and others where applicable
- I have enclosed the consent form completed by the individual I wish to be premises supervisor, if applicable
- I understand that I must now advertise my application
- I understand that if I do not comply with the above requirements my application will be rejected

**IT IS AN OFFENCE, LIABLE ON CONVICTION TO A FINE UP TO LEVEL 5 ON THE STANDARD SCALE, UNDER SECTION 158 OF THE LICENSING ACT 2003 TO MAKE A FALSE STATEMENT IN OR IN CONNECTION WITH THIS APPLICATION**

**Part 4 - Signatures** (please read guidance note 10)

Signature of applicant or applicant's solicitor or other duly authorised agent. (Please read guidance note 11)  
If signing on behalf of the applicant please state in what capacity.

Signature 

Date 23.01.2012

Capacity DIRECTOR

For joint applications signature of 2nd applicant, 2nd applicant's solicitor or other authorised agent.  
(Please read guidance note 12)

If signing on behalf of the applicant please state in what capacity.

Signature \_\_\_\_\_

Date

Capacity

Contact name (where not previously given) and postal address for correspondence associated with this application (please read guidance note 13)	
DEE CIFTCI - D CONNECTIONS 649 HIGH ROAD TOTTENHAM LONDON	
Post town <u>N17 8AA</u>	Postcode <u>N17 8AA</u>
Telephone number (if any) <u>07939466335</u>	
If you would prefer us to correspond with you by e-mail your e-mail address (optional) <u>dilek.ciftci@hotmail.co.uk</u>	

**Notes for Guidance**

1. Describe the premises. For example the type of premises, its general situation and layout and any other information which could be relevant to the licensing objectives. Where your application includes off-supplies of alcohol and you intend to provide a place for consumption of these off-supplies you must include a description of where the place will be and its proximity to the premises.
  2. Where taking place in a building or other structure please tick as appropriate. Indoors may include a tent.
  3. For example the type of activity to be authorised, if not already stated, and give relevant further details, for example (but not exclusively) whether or not music will be amplified or unamplified.
  4. For example (but not exclusively), where the activity will occur on additional days during the summer months.
  5. For example (but not exclusively), where you wish the activity to go on longer on a particular day e.g. Christmas Eve.
  6. Please give timings in 24 hour clock (e.g. 16:00) and only give details for the days of the week when you intend the premises to be used for the activity.
  7. If you wish people to be able to consume alcohol on the premises please tick 'on the premises', if you wish people to be able to purchase alcohol to consume away from the premises please tick 'off the premises'. If you wish people to be able to do both please tick 'both'.
  8. Please give information about anything intended to occur at the premises or ancillary to the use of the premises which may give rise to concern in respect of children, regardless of whether you intend children to have access to the premises, for example (but not exclusively) nudity or semi-nudity, films for restricted age groups, the presence of gaming machines.
  9. Please list here steps you will take to promote all four licensing objectives together.
  10. The application form must be signed.
  11. An applicant's agent (for example solicitor) may sign the form on their behalf provided that they have actual authority to do so.
  12. Where there is more than one applicant, both applicants or their respective agents must sign the application form.
  13. This is the address which we shall use to correspond with you about this application.
  14. The information you have provided will be held by the Council on computerised and manual files. The data may also be disclosed to other departments within the Council or other organisations, but only in order to ensure compliance with relevant legislation or to detect and prevent fraud or a crime.
-



APPENDIX 2—COMMENTS OF  
METROPOLITAN POLICE



Working together for a safer London

### POLICE REPRESENTATION

Name and address of premises:

369 Green Lanes N4 1DY

Type of Application: New Premises Licence.

I wish to make representation on the following:

- Prevention of crime and disorder

If this application were granted in full or part, I would recommend the following alterations be made to the licence conditions. I also suggest that additional conditions be attached to the licence, as set out below, to further promote the licensing objectives.

	Current Conditions	Recommendation
1	CCTV System will be installed.	<p>A digital CCTV system to be installed in the premises.</p> <p>Cameras must be sited to observe the entrance doors from the inside.</p> <p>Cameras on the entrances must capture full frame shots of the heads and shoulders of all people entering the premises i.e. capable of identification.</p> <p>Provide a linked record of the date, time, and place of any image.</p> <p>Provide good quality images - colour during opening times.</p>

		<p>Have a monitor to review images and recorded quality.</p> <p>Be regularly maintained to ensure continuous quality of image capture and retention.</p> <p>Staff trained in operating CCTV.</p> <p>Digital images must be kept for 31 days. The equipment must have a suitable export method, e.g. CD/DVD writer so that Police can make an evidential copy of the data they require. Copies must be available within a reasonable time to Police on request.</p>
--	--	--

If these conditions were accepted in full I would withdraw my representation.

Officer: Mark Greaves  
Licensing Officer Haringey Police

Tel: 020 3276 0150

Mark.Greaves@Met.Police.UK

Date: 10th March 2012

## APPENDIX 3—COMMENTS OF ENVIRONMENTAL HEALTH

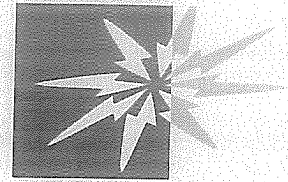

**Haringey** Council

## Licensing Consultation

To: Licensing Officer

From: Enforcement Response Officer (Noise)

Name of Officer preparing representation: George Roberts

cc: Team Leader Enforcement Response, Derek Pearce

Our Reference: WK/000210597

Date: 17th February 2012

Premises: 369 Green Lanes, Hornsey, London, N4 1DY

Type of application: New

---

I would like to confirm that I have considered the above proposal with regard to the prevention of public nuisance on behalf of the Enforcement Response (Noise) Team & would like to make representations to the Application

The operating schedule does not address the prevention of public nuisance from:

- airborne entertainment noise
- Noise generated by patrons in external areas of the premises
- Noise from patrons exiting the premises
- Noise generated from deliveries
- Noise generated from refuse collections
- Noise from plant and machinery
- Light nuisance
- Cooking odour

The proposed operating hours are inappropriate due to the close proximity of residential dwellings

Supporting Information



No record of any enforcement actions taken by our team against premises.

If the sub-committee were to grant this application then we would recommend the following alterations/conditions to the operating schedule:

### **Prevention of nuisance from noise**

All doors and windows will remain closed during the licensed regulated entertainment activities or in any event after 11pm. The entrance door will be fitted with a self-closing device and staff required to ensure that it is not propped open. A member of staff shall be made responsible to ensure the door is opened for as brief a period as possible. Where necessary adequate and suitable mechanical ventilation should be provided to public areas

### **Sound limits**

The licensee shall ensure that no music played in the licensed premises is audible at or within the site boundary of any residential property

### **Outside Areas**

No regulated entertainment will be played in, or for the benefit of patrons in external areas of the premises

No form of loudspeaker or sound amplification equipment is to be sited on or near the exterior premises or in or near any foyer, doorway, window or opening to the premises

Signs shall be displayed in the external rear area requesting patrons to recognise the residential nature of the area and conduct their behaviour accordingly. The management must reserve the right to ask patrons to move inside the premises or leave if it is felt that they could be disturbing neighbours

The external rear area can only be used during the following times:

Sundays from 10am to 9pm  
Monday to Thursday from 8am to 9pm  
Friday and Saturday from 8am to 10.30 pm

### **Deliveries and collections.**

Deliveries and collections associated with the premises will be arranged between the hours 8am to 6pm Mondays to Saturdays so as to minimise the disturbance caused to the neighbours

Glasses will be collected from the external area at the beginning of the day rather than at closing time when neighbours in close proximity might be unduly disturbed

Empty bottles and non-degradable refuse will remain in the premises at the end of trading hours and taken out to the refuse point at the start of the working day rather than at the end of trading when neighbours might be unduly disturbed

### Plant and machinery

All plant and machinery is correctly maintained and regularly serviced to ensure that it is operating efficiently and with minimal disturbance to neighbours arising from noise

### Patrons entering/exiting premises.

Signs should be displayed requesting patrons to respect the neighbours and behave in a courteous manner

### Prevention of Nuisance from Odour

All ventilation and extraction systems shall be correctly maintained and regularly serviced to ensure that it is operating efficiently and with minimal disturbance to neighbours arising from odour.

### Prevention of nuisance from light

Security lights will be positioned to minimise light intrusion to nearby residential premises

## APPENDIX 4—COMMENTS OF PLANNING SERVICE

**Olson Kendra**

---

**From:** Barrett Daliah  
**Sent:** 23 February 2012 15:04  
**To:** Olson Kendra  
**Subject:** Fw: Plan of premises for 369 Green Lanes

----- Original Message -----

**From:** Joyce Myles  
**Sent:** Thursday, February 23, 2012 02:59 PM  
**To:** Barrett Daliah  
**Subject:** RE: Plan of premises for 369 Green Lanes

Dear Daliah,

Planning Enforcement note that there is a 1987 planning permission for change of use to a take-away. This use then A3 also incorporated bars and cafes which are now under A3 and A4 respectively. Although a take way is now classed as A5, a change of use to either A3 or A4 is allowed under the Use Classed Order 1987 (as amended in 2005).

Accordingly the change of sue is allowed and Planning Enforcement have no objection to this licence application.

Myles Joyce Team Leader  
Planning Enforcement and Appeals  
6th Floor River Park House  
225 High Road  
London N22 8HQ  
Tel: 0208 489 5102  
Mobile: 07967336315  
PLEASE NOTE I WORK A TUES-FRIDAY WEEK

-----Original Message-----

**From:** Liu Isaac Hin On Behalf Of Planning Enforcement  
**Sent:** 17 February 2012 15:15  
**To:** Joyce Myles  
**Subject:** FW: Plan of premises for 369 Green Lanes  
**Importance:** High

Dear Myles,

Please find a plan for the above address.

Many thanks,

Kind Regards

Isaac Liu

Development Management Support Team  
Planning, Regeneration & Economy  
Place & Sustainability Directorate  
London Borough of Haringey  
6th Floor, River Park House  
225 High Road  
London N22 8HQ

-----Original Message-----

**From:** Olson Kendra  
**Sent:** 17 February 2012 15:13  
**To:** Building Control; 'KEVIN.CLOSE@london-fire.gov.uk'; Enforcement Response; Whitehouse Rebecca  
**Cc:** Barrett Daliah; Pearce Derek; Planning Enforcement; Shah Noshaba

**Licensing Act 2003 Sub-Committee on 10<sup>th</sup> April 2012**

**Report title: Application for a New Premises Licence at TRADITIONAL TURKISH COFFEE HOUSE, REAR OF 63 GRAND PARADE, GREEN LANES, LONDON N4 1AF**

**Report of: The Lead Officer Licensing**

**Ward(s) affected St Ann's**

**1. Purpose**

**To consider an application by Celal Tasci to allow Supply of Alcohol & The Provision of Late Night Refreshment.**

**2. Recommendations**

- 2.1 (a) Grant the application as asked**  
**(b) Modify the conditions of the licence, by altering or omitting or adding to them**  
**(c) Reject the whole or part of the application**

**The Committee is asked to note that it may not modify the conditions or reject the whole or part of the application unless it is necessary to promote the licensing objectives.**

**Report authorised by: Joan Hancox**

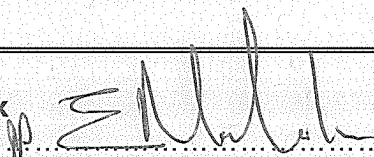

**Head of Neighbourhood Services**

**Contact Officer: Ms Daliah Barrett -Williams**

**Telephone: 020 8489 8232**

**3. Executive summary**

**For consideration by Licensing Sub Committee under Licensing Act 2003 for a Premises licence with variation to the existing conditions**

**4. Access to information:**

**Local Government (Access to Information) Act 1985**

**Background Papers**

**The following Background Papers are used in the preparation of this Report:**

**File: Traditional Turkish Coffee House**

**The Background Papers are located at Enforcement Service, Technopark, Ashley Road, Tottenham N17**

This page is intentionally left blank



## 5.6 Child Protection

To protect the children from harm we have following steps taken:

1. The premises are effectively and responsibly managed.
2. Provision of a sufficient number of people employed or engaged.
3. Appropriate instruction, training and supervision of those employed or engaged.
4. To adopt Challenge 21 Policy.

## 6. RELEVANT REPRESENTATIONS (CONSULTATION)

**Responsible authorities:**

### 6.1 Comments of Metropolitan Police

Have made representation regarding the installation of CCTV and they have also raised concerns about the citing of the premises and the alleyway that leads to the entrance. APP 2

### 6.2 Comments of Regulatory Services:

**Environmental Health**

Have made representation regarding this application and have a number of conditions be attached if the Panel were minded to grant the application. APP 3

**Trading Standards**

Have made no representation to this application

### 6.3 London Fire and Civil Defence Authority

Have made no representation to this application

### 6.4 Planning Services

Comments made regarding this application. APP 4

### 6.5 Comments of Child Protection Agency or Nominee

No representation made on this matter

## 7.0 Interested Parties – APP 5

Letters of representation has been received against this application.

## 8.0 Financial Comments

The fee which would be applicable for this application was **£190.00.**

## APPENDIX 1-- APPLICATION



- e) the proprietor of an educational establishment  please complete section (B)
- f) a health service body  please complete section (B)
- g) a person who is registered under Part 2 of the Care Standards Act 2000 (c14) in respect of an independent hospital  please complete section (B)
- h) the chief officer of police of a police force in England and Wales  please complete section (B)

\* If you are applying as a person described in (a) or (b) please confirm:

Please tick yes

- I am carrying on or proposing to carry on a business which involves the use of the premises for licensable activities; or
- I am making the application pursuant to a
  - statutory function or
  - a function discharged by virtue of Her Majesty's prerogative

**(A) INDIVIDUAL APPLICANTS** (fill in as applicable)

Mr <input checked="" type="checkbox"/>	Mrs <input type="checkbox"/>	Miss <input type="checkbox"/>	Ms <input type="checkbox"/>	Other Title (for example, Rev)	
Surname Tasci			First names Celal		
I am 18 years old or over				<input checked="" type="checkbox"/> Please tick yes	
Current postal address if different from premises address		46 COVERACK CLOSE			
Post Town	LONDON		Postcode	N14 4QP	
Daytime contact telephone number					
E-mail address (optional)					

**SECOND INDIVIDUAL APPLICANT** (if applicable)

Mr <input type="checkbox"/>	Mrs <input type="checkbox"/>	Miss <input type="checkbox"/>	Ms <input type="checkbox"/>	Other Title (for example, Rev)	
Surname			First names		
I am 18 years old or over				<input type="checkbox"/> Please tick yes	

Current postal address if different from premises address			
Post Town		Postcode	
Daytime contact telephone number			
E-mail address (optional)			

**(B) OTHER APPLICANTS**

Please provide name and registered address of applicant in full. Where appropriate please give any registered number. In the case of a partnership or other joint venture (other than a body corporate), please give the name and address of each party concerned.

Name
Address
Registered number (where applicable)
Description of applicant (for example, partnership, company, unincorporated association etc.)
Telephone number (if any)
E-mail address (optional)

**Part 3 Operating Schedule**

When do you want the premises licence to start?

Day	Month	Year
1	2	0 1 2 0 1 2

If you wish the licence to be valid only for a limited period, when do you want it to end?

Day	Month	Year

Please give a general description of the premises (please read guidance note1)  
Please refer to the enclosed plan.

If 5,000 or more people are expected to attend the premises at any one time, please state the number expected to attend.

What licensable activities do you intend to carry on from the premises?

(Please see sections 1 and 14 of the Licensing Act 2003 and Schedules 1 and 2 to the Licensing Act 2003)

**Provision of regulated entertainment**

**Please tick yes**

- a) plays (if ticking yes, fill in box A)
- b) films (if ticking yes, fill in box B)
- c) indoor sporting events (if ticking yes, fill in box C)
- d) boxing or wrestling entertainment (if ticking yes, fill in box D)
- e) live music (if ticking yes, fill in box E)
- f) recorded music (if ticking yes, fill in box F)
- g) performances of dance (if ticking yes, fill in box G)
- h) anything of a similar description to that falling within (e), (f) or (g) (if ticking yes, fill in box H)

**Provision of entertainment facilities:**

- i) making music (if ticking yes, fill in box I)
- j) dancing (if ticking yes, fill in box J)
- k) entertainment of a similar description to that falling within (i) or (j) (if ticking yes, fill in box K)

**Provision of late night refreshment** (if ticking yes, fill in box L)

**Supply of alcohol** (if ticking yes, fill in box M)

In all cases complete boxes N, O and P

A

<b>Plays</b> Standard days and timings (please read guidance note 6)			<b>Will the performance of a play take place indoors or outdoors or both – please tick</b> (please read guidance note 2)	Indoors	<input type="checkbox"/>
				Outdoors	<input type="checkbox"/>
				Both	<input type="checkbox"/>
Day	Start	Finish	<b>Please give further details here</b> (please read guidance note 3)		
Mon					
Tue					
Wed			<b>State any seasonal variations for performing plays</b> (please read guidance note 4)		
Thur					
Fri			<b>Non standard timings. Where you intend to use the premises for the performance of plays at different times to those listed in the column on the left, please list</b> (please read guidance note 5)		
Sat					
Sun					

**B**

<b>Films</b> Standard days and timings (please read guidance note 6)			<b><u>Will the exhibition of films take place indoors or outdoors or both – please tick</u></b> (please read guidance note 2)	Indoors	<input type="checkbox"/>
				Outdoors	<input type="checkbox"/>
				Both	<input type="checkbox"/>
<b>Day</b>	<b>Start</b>	<b>Finish</b>	<b><u>Please give further details here</u></b> (please read guidance note 3)		
Mon					
Tue					
Wed					
Thur					
Fri					
Sat					
			<b><u>State any seasonal variations for the exhibition of films</u></b> (please read guidance note 4)		
			<b><u>Non standard timings. Where you intend to use the premises for the exhibition of films at different times to those listed in the column on the left, please list</u></b> (please read guidance note 5)		
Sun					

C

Indoor sporting events Standard days and timings (please read guidance note 6)			<u>Please give further details</u> (please read guidance note 3)
Day	Start	Finish	
Mon			
Tue			<u>State any seasonal variations for indoor sporting events</u> (please read guidance note 4)
Wed			<u>Non standard timings. Where you intend to use the premises for indoor sporting events at different times to those listed in the column on the left, please list</u> (please read guidance note 5)
Thur			
Fri			
Sat			
Sun			

D

<b>Boxing or wrestling entertainments</b> Standard days and timings (please read guidance note 6)			<b><u>Will the boxing or wrestling entertainment take place indoors or outdoors or both – please tick</u></b> (please read guidance note 2)		Indoors	<input type="checkbox"/>
					Outdoors	<input type="checkbox"/>
Day	Start	Finish	<b><u>Please give further details here</u></b> (please read guidance note 3)			
Mon						
Tue			<b><u>State any seasonal variations for boxing or wrestling entertainment</u></b> (please read guidance note 4)			
Wed						
Thur			<b><u>Non standard timings. Where you intend to use the premises for boxing or wrestling entertainment at different times to those listed in the column on the left, please list</u></b> (please read guidance note 5)			
Fri						
Sat						
Sun						

E

<b>Live music</b> Standard days and timings (please read guidance note 6)			<b>Will the performance of live music take place indoors or outdoors or both – please tick</b> (please read guidance note 2)	Indoors	<input type="checkbox"/>
				Outdoors	<input type="checkbox"/>
				Both	<input type="checkbox"/>
<b>Day</b>	<b>Start</b>	<b>Finish</b>	<b>Please give further details here</b> (please read guidance note 3)		
Mon					
Tue					
<b>Wed</b>			<b>State any seasonal variations for the performance of live music</b> (please read guidance note 4)		
Thur					
<b>Fri</b>			<b>Non standard timings. Where you intend to use the premises for the performance of live music at different times to those listed in the column on the left, please list</b> (please read guidance note 5)		
Sat					
Sun					

F

<b>Recorded music</b> Standard days and timings (please read guidance note 6)			<b>Will the playing of recorded music take place indoors or outdoors or both – please tick</b> (please read guidance note 2)	Indoors	<input type="checkbox"/>
				Outdoors	<input type="checkbox"/>
				Both	<input type="checkbox"/>
Day	Start	Finish			
Mon			<b>Please give further details here</b> (please read guidance note 3)		
Tue					
Wed			<b>State any seasonal variations for the playing of recorded music</b> (please read guidance note 4)		
Thur					
Fri			<b>Non standard timings. Where you intend to use the premises for the playing of recorded music at different times to those listed in the column on the left, please list</b> (please read guidance note 5)		
Sat					
Sun					

G

<b>Performances of dance</b> Standard days and timings (please read guidance note 6)			<b><u>Will the performance of dance take place indoors or outdoors or both – please tick</u></b> (please read guidance note 2)	Indoors	<input type="checkbox"/>
				Outdoors	<input type="checkbox"/>
				Both	<input type="checkbox"/>
Day	Start	Finish	<b><u>Please give further details here</u></b> (please read guidance note 3)		
Mon					
Tue					
Wed			<b><u>State any seasonal variations for the performance of dance</u></b> (please read guidance note 4)		
Thur					
Fri			<b><u>Non standard timings. Where you intend to use the premises for the performance of dance at different times to those listed in the column on the left, please list</u></b> (please read guidance note 5)		
Sat					
Sun					

H

<p>Anything of a similar description to that falling within (e), (f) or (g) Standard days and timings (please read guidance note 6)</p>			<p><u>Please give a description of the type of entertainment you will be providing</u></p>		
Day	Start	Finish	<p><u>Will this entertainment take place indoors or outdoors or both – please tick</u> (please read guidance note 2)</p>	Indoors	<input type="checkbox"/>
Mon				Outdoors	<input type="checkbox"/>
				Both	<input type="checkbox"/>
Tue			<p><u>Please give further details here</u> (please read guidance note 3)</p>		
Wed					
Thur			<p><u>State any seasonal variations for entertainment of a similar description to that falling within (e), (f) or (g)</u> (please read guidance note 4)</p>		
Fri					
Sat			<p><u>Non standard timings. Where you intend to use the premises for the entertainment of a similar description to that falling within (e), (f) or (g) at different times to those listed in the column on the left, please list</u> (please read guidance note 5)</p>		
Sun					

<b>Provision of facilities for making music</b> Standard days and timings (please read guidance note 6)			<u>Please give a description of the facilities for making music you will be providing</u>	
			<u>Will the facilities for making music be indoors or outdoors or both – please tick</u> (please read guidance note 2)	
Day	Start	Finish	Indoors	<input type="checkbox"/>
			Outdoors	<input type="checkbox"/>
			Both	<input type="checkbox"/>
Mon			<u>Please give further details here</u> (please read guidance note 3)	
Tue				
Wed			<u>State any seasonal variations for the provision of facilities for making music</u> (please read guidance note 4)	
Thur				
Fri			<u>Non standard timings. Where you intend to use the premises for provision of facilities for making music at different times to those listed in the column on the left, please list</u> (please read guidance note 5)	
Sat				
Sun				

J

<b>Provision of facilities for dancing</b> Standard days and timings (please read guidance note 6)			<b><u>Will the facilities for dancing be indoors or outdoors or both – please tick (see guidance note 2)</u></b>	Indoors <input type="checkbox"/>
				Outdoors <input type="checkbox"/>
				Both <input type="checkbox"/>
<b>Day</b>	<b>Start</b>	<b>Finish</b>	<b><u>Please give a description of the facilities for dancing you will be providing</u></b>	
Mon			<b><u>Please give further details here (please read guidance note 3)</u></b>	
Tue				
Wed			<b><u>State any seasonal variations for providing dancing facilities (please read guidance note 4)</u></b>	
Thur				
Fri			<b><u>Non standard timings. Where you intend to use the premises for the provision of facilities for dancing entertainment at different times to those listed in the column on the left, please list (please read guidance note 5)</u></b>	
Sat				
Sun				

K

<p><b>Provision of facilities for entertainment of a similar description to that falling within i or j</b> Standard days and timings (please read guidance note 6)</p>			<p><b><u>Please give a description of the type of entertainment facility you will be providing</u></b></p>		
Day	Start	Finish	<p><b><u>Will the entertainment facility be indoors or outdoors or both – please tick</u></b> (please read guidance note 2)</p>	Indoors	<input type="checkbox"/>
Mon				Outdoors	<input type="checkbox"/>
				Both	<input type="checkbox"/>
Tue			<p><b><u>Please give further details here</u></b> (please read guidance note 3)</p>		
Wed					
Thur			<p><b><u>State any seasonal variations for the provision of facilities for entertainment of a similar description to that falling within i or j</u></b> (please read guidance note 4)</p>		
Fri					
Sat			<p><b><u>Non standard timings. Where you intend to use the premises for the provision of facilities for entertainment of a similar description to that falling within i or j at different times to those listed in the column on the left, please list</u></b> (please read guidance note 5)</p>		
Sun					

L

Late night refreshment Standard days and timings (please read guidance note 6)			Will the provision of late night refreshment take place indoors or outdoors or both – please tick (please read guidance note 2)	Indoors	<input checked="" type="checkbox"/>
				Outdoors	<input type="checkbox"/>
				Both	<input type="checkbox"/>
Day	Start	Finish			
Mon	23:00	00:00	<b>Please give further details here</b> (please read guidance note 3)		
Tue	23:00	00:00			
Wed	23:00	00:00	<b>State any seasonal variations for the provision of late night refreshment</b> (please read guidance note 4)		
Thur	23:00	00:00			
Fri	23:00	00:00	<b>Non standard timings. Where you intend to use the premises for the provision of late night refreshment at different times, to those listed in the column on the left, please list</b> (please read guidance note 5)		
Sat	23:00	00:00			
Sun	23:00	00:00			

M

<b>Supply of alcohol</b> Standard days and timings (please read guidance note 6)			<b>Will the supply of alcohol be for consumption (Please tick box)</b> (please read guidance note 7)	On the premises	<input checked="" type="checkbox"/>
				Off the premises	<input type="checkbox"/>
				Both	<input type="checkbox"/>
<b>Day</b>	<b>Start</b>	<b>Finish</b>	<b>State any seasonal variations for the supply of alcohol</b> (please read guidance note 4) N/A		
Mon	11:00	00:00			
Tue	11:00	00:00			
Wed	11:00	00:00			
Thur	11:00	00:00			
Fri	11:00	00:00			
Sat	11:00	00:00			
Sun	11:00	00:00			
			<b>Non standard timings. Where you intend to use the premises for the supply of alcohol at different times to those listed in the column on the left, please list</b> (please read guidance note 5) N/A		

State the name and details of the individual whom you wish to specify on the licence as premises supervisor

<b>Name</b> Celal Tasci	
<b>Address</b> 46 Coverack Close London	
<b>Postcode</b>	N14 4QP
<b>Personal Licence number (if known)</b> Not Known Yet	
<b>Issuing licensing authority (if known)</b> London Borough of Enfield	

N

**Please highlight any adult entertainment or services, activities, other entertainment or matters ancillary to the use of the premises that may give rise to concern in respect of children (please read guidance note 8)**  
 N/A

O

<b>Hours premises are open to the public</b> Standard days and timings (please read guidance note 6)			<b>State any seasonal variations</b> (please read guidance note 4) N/A
Day	Start	Finish	
Mon	11:00	00:30	
Tue	11:00	00:30	
Wed	11:00	00:30	
Thur	11:00	00:30	
Fri	11:00	00:30	
Sat	11:00	00:30	
Sun	11:00	00:30	
			<b>Non standard timings. Where you intend the premises to be open to the public at different times from those listed in the column on the left, please list</b> (please read guidance note 5)

**P** Describe the steps you intend to take to promote the four licensing objectives:

**a) General – all four licensing objectives (b,c,d,e) (please read guidance note 9)**

The standard practices listed below will be maintained at all times. All reasonable steps will be taken to ensure that the premises will have a positive impact upon the local environment and its residents at all times.

**b) The prevention of crime and disorder**

CCTV shall be installed, operated and maintained in agreement with the Police. The system will enable a frontal head and shoulders image of every person entering the premises. The system shall record in real time and operate whilst the premises are open for licensable activities. The recordings shall be kept available for a minimum of 31 days. Recordings shall be made available to an Authorised Officer or a Police Officer (subject to the Data Protection Act 1998) within 24 hours of any request.

**c) Public safety**

Appropriate fire safety procedures are in place along with appliances including fire extinguishers (Foam, H2O and CO2), fire blankets, internally illuminated fire exit signs, a smoke detector and emergency lighting. All appliances are checked annually and comply with relevant British Standards.

All fire escapes/escape routes will be clearly marked and kept free from obstructions at all times.

**d) The prevention of public nuisance**

All customers are asked to leave quietly. Clear and legible notices will be displayed to remind customers to leave quietly.

**e) The protection of children from harm**

To protect the children from harm we have following steps taken:

- 1- the premises are effectively and responsibly managed
- 2- provision of a sufficient number of people employed or engaged
- 3- appropriate instruction, training and supervision of those employed or engaged
- 4- to adopt Challenge 21 Policy.

Please tick yes

- I have made or enclosed payment of the fee
- I have enclosed the plan of the premises
- I have sent copies of this application and the plan to responsible authorities and others where applicable
- I have enclosed the consent form completed by the individual I wish to be premises supervisor, if applicable
- I understand that I must now advertise my application
- I understand that if I do not comply with the above requirements my application will be rejected

**IT IS AN OFFENCE, LIABLE ON CONVICTION TO A FINE UP TO LEVEL 5 ON THE STANDARD SCALE, UNDER SECTION 158 OF THE LICENSING ACT 2003 TO MAKE A FALSE STATEMENT IN OR IN CONNECTION WITH THIS APPLICATION**

**Part 4 – Signatures** (please read guidance note 10)

Signature of applicant or applicant's solicitor or other duly authorised agent (See guidance note 11). If signing on behalf of the applicant please state in what capacity.

Signature	
Date	14 December 2011
Capacity	Authorised Agent

For joint applications signature of 2<sup>nd</sup> applicant or 2<sup>nd</sup> applicant's solicitor or other authorised agent. (please read guidance note 12). If signing on behalf of the applicant please state in what capacity.

Signature	
Date	
Capacity	

Contact name (where not previously given) and postal address for correspondence associated with this application (please read guidance note 13)

Licensing Department  
NARTS  
55 Stoke Newington High Street

Post town	London	Post code	N16 8EL
Telephone number (if any)	020 7241 3636		
If you would prefer us to correspond with you by e-mail your e-mail address (optional) info@act2003.com			

Consent of individual to being specified as premises supervisor

I CELAL TASCI  
[full name of prospective premises supervisor]

of 46 COVERACK, Cloke  
London  
N14 4QP

-----  
[home address of prospective premises supervisor]

hereby confirm that I give my consent to be specified as the designated premises supervisor in relation to the application for

New Application for Premises Licence  
[type of application]

by

Celal Tasci  
[name of applicant]

relating to a premises licence Not known yet  
[number of existing licence, if any]

for Traditional Turkish Coffee House  
Rear of 63 Grand Parade  
Green Lanes  
London, N14 1AF

-----  
[name and address of premises to which the application relates]

and any premises licence to be granted or varied in respect of this application made by

Celal Tasci

[name of applicant]

concerning the supply of alcohol at

Traditional Turkish Coffee House  
Res of 63 Grand Parade  
Green Lanes  
London  
N4 1AF

[name and address of premises to which application relates]

I also confirm that I am applying for, intend to apply for or currently hold a personal licence, details of which I set out below.

Personal licence number

Application in Progress

[insert personal licence number, if any]

Personal licence issuing authority

London Borough of Enfield

[insert name and address and telephone number of personal licence issuing authority, if any]

Signed



Name (please print)

CELAL TASCİ

Date

14 December 2011

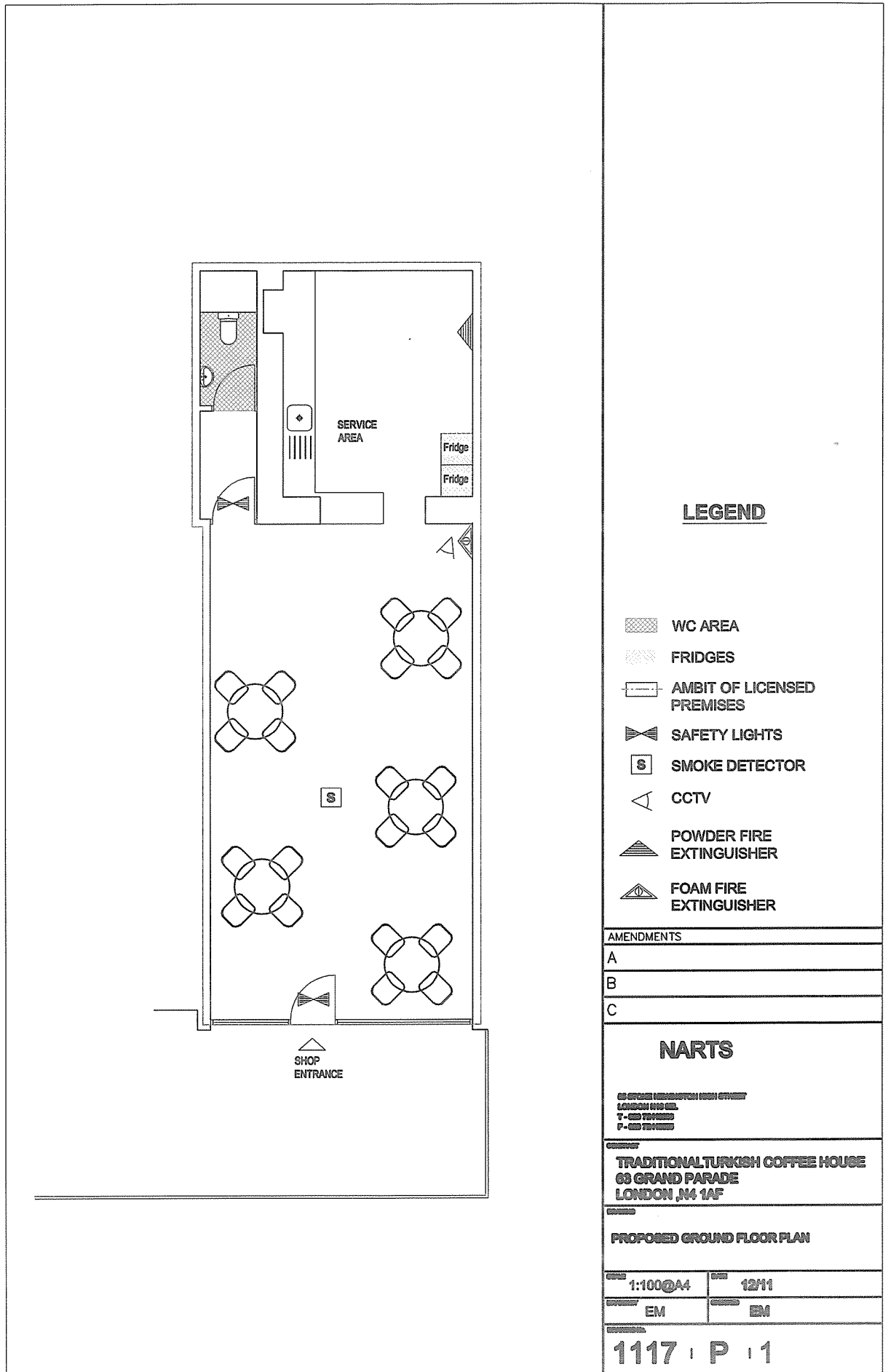

**LEGEND**

- WC AREA
- FRIDGES
- AMBIT OF LICENSED PREMISES
- SAFETY LIGHTS
- SMOKE DETECTOR
- CCTV
- POWDER FIRE EXTINGUISHER
- FOAM FIRE EXTINGUISHER

AMENDMENTS

- A
- B
- C

**NARTS**

63 GRAND PARADE HIGH STREET  
LONDON N4 6EL  
T - 020 7499 8888  
F - 020 7499 8888

**TRADITIONAL TUNKISH COFFEE HOUSE**  
**63 GRAND PARADE**  
**LONDON, N4 1AF**

**PROPOSED GROUND FLOOR PLAN**

SCALE 1:100 @ A4	DATE 12/11
DESIGNER EM	CHECKER EM

**1117 | P | 1**

## APPENDIX 2—COMMENTS OF METROPOLITAN POLICE

**Olson Kendra**

---

**From:** Mark.L.Greaves@met.pnn.police.uk  
**Sent:** 10 March 2012 08:50  
**To:** Olson Kendra  
**Cc:** Barrett Daliah; Jono.D.Clay-Michael@met.police.uk; Diane.Blumsom@met.police.uk; Paul.Davies2@met.police.uk  
**Subject:** RE: New Premises licence application for: Traditional Turkish Coffee House, Rear of 63 Grand Parade, Green Lanes, N4 1AF (WK000207762)  
**Follow Up Flag:** Follow up  
**Flag Status:** Red  
**Attachments:** Reps to application Traditional Turkish Coffee House.docm

Hi Kendra

I have spoken with Sgt Clay-Michael, St Ann's SNT, about his views on this application and visited the venue with Sgt Davies. During our visit we spoke with the licensee of the restaurant next door regarding his concerns about the access gate at the rear of his venue which are reflected by Sgt Clay-Michael. Licensee states he often finds used condoms in the alley in the mornings and that allowing this application would leave the alley insecure at night thus allowing prostitutes to enter. As he is finding condoms each morning before this application is approved it would suggest the gate is not being locked at night at present. The gate may also be a fire exit. I have therefore made Representations regarding this entry point along with CCTV requirements and have attached them. I feel this gate should be secured at night to prevent access by prostitutes and drug users and that the landlord / venue licensees could enable this as stated in my Reps.

Regards

Mark

*Mark Greaves PC 164YR  
Licensing / CPDA / Crime Prevention  
Haringey Borough Police*

*Tel: 020 3276 0150*

**This Message is Restricted/Confidential**

**If Printed please remember to dispose of as Confidential Waste**

---

**From:** Olson Kendra [mailto:Kendra.Olson@haringey.gov.uk]  
**Sent:** 21 February 2012 09:51  
**To:** Greaves Mark L - YR; Thorpe Christopher S - YR; Pearce Derek; 'firesafetyregulationNW@london-fire.gov.uk'; Planning Enforcement; Building Control; Boeuf Paul; Pearce Derek; Enforcement Response; Whitehouse Rebecca; Food Haringey; Blumsom Diane - YR  
**Cc:** Barrett Daliah; Smith Paul; Shah Noshaba  
**Subject:** New Premises licence application for: Traditional Turkish Coffee House, Rear of 63 Grand Parade, Green Lanes, N4 1AF (WK000207762)

Dear All

Please note the consultation has restarted again on this application. The last day for representations is the 18<sup>th</sup> March 2012.

12/03/2012

APPENDIX 2B – ORIGINAL  
REPRESENTATION OF  
METROPOLITAN POLICE, NOW  
WITHDRAWN

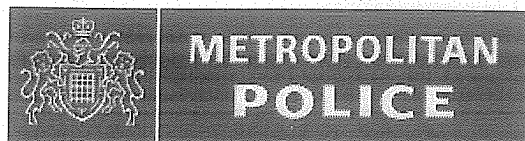

Working together for a safer London

### POLICE REPRESENTATION

Name and address of premises:

**Traditional Turkish Coffee House, Rear of 63 Grand Parade N4**

Type of Application: New Premises Licence.

I wish to make representation on the following:

- Prevention of crime and disorder

If this application were granted in full or part, I would recommend the following alterations be made to the licence conditions. I also suggest that additional conditions be attached to the licence, as set out below, to further promote the licensing objectives.

	Current Conditions	Recommendation
1	CCTV System will be installed.	<p>A digital CCTV system to be installed in the premises.</p> <p>Cameras must be sited to observe the entrance doors from the inside.</p> <p>Cameras on the entrances must capture full frame shots of the heads and shoulders of all people entering the premises i.e. capable of identification.</p> <p>Provide a linked record of the date, time, and place of any image.</p> <p>Provide good quality images - colour during opening times.</p>

2		<p>Have a monitor to review images and recorded quality.</p> <p>Be regularly maintained to ensure continuous quality of image capture and retention.</p> <p>Staff trained in operating CCTV.</p> <p>Digital images must be kept for 31 days. The equipment must have a suitable export method, e.g. CD/DVD writer so that Police can make an evidential copy of the data they require. Copies must be available within a reasonable time to Police on request.</p> <p>This venue's access point from the street is via an alley controlled by a 6' metal gate. It is known that prostitutes and drug users use this alley at night leaving behind debris therefore the gate needs to be shut. As this is the only exit from the rear for a neighbouring late night venue then it could well be considered a fire exit and therefore should not be locked until all venues using the exit have closed. This could be overcome by fitting a release mechanism inside the gate enabling exit from inside when gate is locked. When a decision regarding fire regulations is reached regarding this exit point, should it require</p>
---	--	---

		applicant to ensue it is secured at the end of his licensed hours then he must do so.
--	--	---

If these conditions were accepted in full I would withdraw my representation.

Officer: Mark Greaves  
Licensing Officer Haringey Police

Tel: 020 3276 0150

Mark.Greaves@Met.Police.UK

Date: 10th March 2012



Working together for a safer London

**POLICE REPRESENTATION**

**Name and address of premises:**

**Traditional Turkish Coffee House, Rear of 63 Grand Parade N4**

**Type of Application:** New Premises Licence.

**I wish to make representation on the following:**

- Prevention of crime and disorder

If this application were granted in full or part, I would recommend the following alterations be made to the licence conditions. I also suggest that additional conditions be attached to the licence, as set out below, to further promote the licensing objectives.

	<b>Current Conditions</b>	<b>Recommendation</b>
1	CCTV System will be installed.	<p>A digital CCTV system to be installed in the premises.</p> <p>Cameras must be sited to observe the entrance doors from the inside.</p> <p>Cameras on the entrances must capture full frame shots of the heads and shoulders of all people entering the premises i.e. capable of identification.</p> <p>Provide a linked record of the date, time, and place of any image.</p> <p>Provide good quality images - colour during opening times.</p>

		<p>Have a monitor to review images and recorded quality.</p> <p>Be regularly maintained to ensure continuous quality of image capture and retention.</p> <p>Staff trained in operating CCTV.</p> <p>Digital images must be kept for 31 days. The equipment must have a suitable export method, e.g. CD/DVD writer so that Police can make an evidential copy of the data they require. Copies must be available within a reasonable time to Police on request.</p>
--	--	--

If these conditions were accepted in full I would withdraw my representation.

Officer: Mark Greaves  
Licensing Officer Haringey Police

Tel: 020 3276 0150

Mark.Greaves@Met.Police.UK

Date: 4th January 2012

**Shah Noshaba**

---

**From:** Mark.L.Greaves@met.pnn.police.uk  
**Sent:** 05 January 2012 13:35  
**To:** ozlem.ozcan@narts.org.uk; Shah Noshaba  
**Cc:** Barrett Daliah  
**Subject:** RE: New Premises licence application for: Traditional Turkish Coffee House, Rear of 63 Grand Parade, Green Lanes, N4 1AF (WK000207762)

Thank you Mr Ozcan.

Police withdraw their Representations.

Regards

Mark

**Mark Greaves PC 164YR**  
**Crime Prevention Officer / CPDA / Licensing**  
**Haringey Borough Police**

**Tel: 0208 3452164**

**This Message is Restricted/Confidential**  
**If Printed please remember to dispose of as Confidential Waste**

---

**From:** Ozlem Ozcan [ Licensing ] [mailto:ozlem.ozcan@narts.org.uk]  
**Sent:** 05 January 2012 13:28  
**To:** Shah Noshaba  
**Cc:** Greaves Mark L - YR  
**Subject:** RE: New Premises licence application for: Traditional Turkish Coffee House, Rear of 63 Grand Parade, Green Lanes, N4 1AF (WK000207762)

Dear Sir/ Madam

Please be advised that the applicant is accepting all the conditions proposed by the Police.

Many Thanks,

Ozlem Ozcan  
020 7241 3636

---

**From:** Shah Noshaba [mailto:Noshaba.Shah@haringey.gov.uk]  
**Sent:** Wednesday, January 04, 2012 9:06 AM  
**To:** 'info@act2003.com'  
**Subject:** New Premises licence application for: Traditional Turkish Coffee House, Rear of 63 Grand Parade, Green Lanes, N4 1AF (WK000207762)

Dear Sir/ Madam

Please find attached objections to the aforementioned application from the Police received on 04<sup>th</sup>

This page is intentionally left blank

## APPENDIX 3—COMMENTS OF ENVIRONMENTAL HEALTH

Olson Kendra

---

**From:** Nicolaou George (Enforcement)

**Sent:** 28 January 2012 09:15

**To:** Pearce Derek

**Cc:** Barrett Daliah

**Subject:** WK/000207762

Licensing Consultation

To: Licensing Officer

From: Enforcement Response Officer (Noise)

Name of Officer preparing representation:

cc: Team Leader Enforcement Response, Derek Pearce

Our Reference: WK/000207762

Date: 26th January 2012

Premises: Traditional Turkish Coffee House, Rear Store, 63 Grand Parade, Tottenham, London, N4 1AF

Type of application: New

---

I would like to confirm that I have considered the above proposal with regard to the prevention of public nuisance on behalf of the Enforcement Response (Noise) Team & would like to make representations to the Application

The operating schedule does not address the prevention of public nuisance from:

- Noise generated by patrons in external areas of the premises
- Noise generated from patrons queuing to enter
- Noise generated from deliveries
- Noise generated from refuse collections
- Noise from plant and machinery
- Light nuisance
- Cooking odour

#### Supporting Information

The picture below shows views from the premises :-



### **Prevention of nuisance from noise / vibration**

All doors and windows will remain closed during the licensed activities or in any event after 9pm. The entrance door will be fitted with a self-closing device and staff required to ensure ensure that it is not propped open. A member of staff shall be made responsible to ensure the door is opened for as brief a period as possible. Where necessary adequate and suitable mechanical ventilation should be provided to public areas

The licensable activity shall conclude 30 minutes before the premises is due to close to prevent excessive noise breakout as the premises empties

### **Structure borne noise**

All speakers, for background music, are mounted on anti-vibration mountings to prevent vibration transmission of sound energy to adjoining properties.

## Outside Areas

No music will be played in, or for the benefit of patrons in external areas of the premises

No form of loudspeaker or sound amplification equipment is to be sited on or near the exterior premises or in or near any foyer, doorway, window or opening to the premises

Any table and chairs that might be used by the public, must cease to be used by 21:00 due to the close proximity of adjoining property.

Signs shall be displayed in the external areas requesting patrons to recognise the residential nature of the area and conduct their behaviour accordingly. The management must reserve the right to ask patrons to move inside the premises or leave if it is felt that they could be disturbing neighbours

The number of persons permitted to utilise the external area will be restricted to 8 people.

The external area will be closed and patrons requested to come inside the main structure of the premises at 21:00.

The gates at the bottom of the alley should remain open at all times whilst the premises are open.

## Deliveries and collections.

Deliveries and collections associated with the premises will be arranged between the hours 08:00 and 20:00 so as to minimise the disturbance caused to the neighbours

Empty bottles and non-degradable refuse will remain in the premises at the end of trading hours and taken out to the refuse point at the start of the working day rather than at the end of trading when neighbours might be unduly disturbed

## Plant and machinery

All plant and machinery is correctly maintained and regularly serviced to ensure that it is operating efficiently and with minimal disturbance to neighbours arising from noise

## Patrons entering/exiting premises.

There will be no queuing outside the premises.

Where people queue to enter the premises a licensed door supervisor shall supervise and ensure the potential patrons behave in an acceptable manner

Signs should be displayed both inside and outside of the premises requesting patrons to respect the neighbours and behave in a courteous manner

## Prevention of nuisance from litter

Adequate receptacles for use by patrons will be provided in the local vicinity. The positioning of the receptacles will be agreed with the licensing officer

#### **Prevention of Nuisance from Odour**

All ventilation and extraction systems shall be correctly maintained and regularly serviced to ensure that it is operating efficiently and with minimal disturbance to neighbours arising from odour.

#### **Prevention of nuisance from light**

Illuminated external signage shall be switched off when the premises is closed

Security lights will be positioned to minimise light intrusion to nearby residential premises

## APPENDIX 4—COMMENTS OF PLANNING SERVICE

**Olson Kendra**

---

**From:** Barrett Daliah  
**Sent:** 23 February 2012 17:43  
**To:** Olson Kendra  
**Subject:** FW: URGENT! Planning Applications: HGY/2012/0219: rear of no 63 GRAND PARADE N4 1AF - Turkish Coffee House

info

---

**From:** Joyce Myles  
**Sent:** 08 February 2012 15:48  
**To:** 'Andy & Karen'; Ian Sygrave; Cllr Adamou Gina; Cllr Brabazon Zena; Cllr Schmitz David; Cllr Alexander Karen; Cllr Canver Nilgun; Cllr Browne David; Chapman Tony; Hart Steve (NDR); Barrett Daliah  
**Cc:** Germana Canzi GRA; Redfearn Tom; Francois GRA  
**Subject:** RE: URGENT! Planning Applications: HGY/2012/0219: rear of no 63 GRAND PARADE N4 1AF - Turkish Coffee House

Dear all,

By way of update. I have received a response to the PCN issued from the owner of the premises who states that:

- He is the freeholder and that the unit to the rear was already sub-divided more than 15 years ago when he acquired the property.
- He also states that non domestic rates are being paid for both ground floor units- Steve Hart can you confirm from when this split was effective.
- He objects to the proposed change of use under HGY/2012/0219

An alcohol licence is being applied for by a Mr Tasci-

As it stands the proposal would be a material change of use which would be enforceable should it be implemented. The enforcement case will remain open whilst investigations continue.

Yours Sincerely,

**Myles Joyce Team Leader**  
**Planning Enforcement and Appeals**  
**6th Floor River Park House**  
**225 High Road**  
**London N22 8HQ**  
**Tel: 0208 489 5102**  
**Mobile: 07967336315**  
**PLEASE NOTE I WORK A TUES-FRIDAY WEEK**

---

**From:** Andy & Karen [mailto:andyn.kaza@virgin.net]  
**Sent:** 08 February 2012 15:36  
**To:** Joyce Myles; Ian Sygrave; Cllr Adamou Gina; Cllr Brabazon Zena; Cllr Schmitz David; Cllr Alexander Karen; Cllr Canver Nilgun; Cllr Browne David; Chapman Tony  
**Cc:** Germana Canzi GRA; Redfearn Tom; Francois GRA  
**Subject:** Re: URGENT! Planning Applications: HGY/2012/0219: rear of no 63 GRAND PARADE N4 1AF - Turkish Coffee House

Dear All

24/02/2012

This page is intentionally left blank

## APPENDIX 5—COMMENTS OF INTERESTED PARTIES

**Olson Kendra**

---

**From:** Barrett Daliah  
**Sent:** 26 January 2012 13:17  
**To:** Olson Kendra  
**Subject:** Fw: Premises licence by Turkish Traditional Cafe House at rear of 63 Grand Parade, Green Lanes, N4 1AF.

**Follow Up Flag:** Follow up  
**Flag Status:** Completed

**Attachments:** 63 Green Lanes Turkish Cafe-GRA Objection with picts.pdf



63 Green Lanes  
Turkish Cafe-GR...

----- Original Message -----

**From:** gra [mailto:gra@ballay1.demon.co.uk]  
**Sent:** Thursday, January 26, 2012 01:01 PM  
**To:** Barrett Daliah  
**Subject:** RE: Premises licence by Turkish Traditional Cafe House at rear of 63 Grand Parade, Green Lanes, N4 1AF.

Dear Daliah Barrett

Please find enclosed the Gardens Residents Association's objection with regard to the Licensing application in reference.

Please let me know when the hearing will take place.

Yours sincerely

Francois Ballay  
Chair Gardens Residents Association

---

This email has been scanned by the Symantec Email Security.cloud service.  
For more information please visit <http://www.symanteccloud.com>

---

Stanhope Gardens - Portland Gardens - Domeston Gardens - Essex Gardens - Grafton Gardens - Rutland Gardens - Devon Gardens

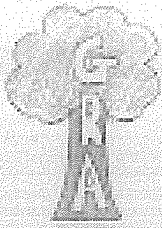

# Gardens Residents Association (GRA)

1998 020 7794 7771 020 7794 7771 020 7794 7771 020 7794 7771

Ms Daliah Barrett  
Lead Licensing Officer  
Haringey Council  
Techno Park  
Ashley Rd  
London N17 9LN

24 January 2012

Dear Daliah Barrett

Re: Premises licence by Turkish Traditional Cafe House at rear of 63 Grand Parade, Green Lanes, N4 1AF. Applying for supply of alcohol 11am to midnight (daily) and late night refreshment 11pm to midnight (daily) with opening hours 11am to 12.30am daily

I am writing on behalf of the Gardens Residents Association (which represents the residents of Stanhope, Portland, Doncaster, Rutland, Roseberry, Chesterfield, Kimberley, Warwick and Cleveland Gardens, all in N4, leading off or close to Green Lanes) to object to the licensing application for the provision of late night refreshment and the supply of alcohol at 63 Green Lanes N4 1AF.

We are aware of several residents directly affected by the proposed operation who have expressed their concerns to us and made individual representations to the Committee.

We object most strongly to this proposal and believe that if permission for this late night opening were granted, it would have a seriously detrimental effect on the people leaving in the vicinity and on the local neighbourhood.

We believe that to grant a licence for the activities and hours requested, in a densely populated residential area, would be against the principles of Haringey's Licensing Policy, specifically under the following headings:

Roseberry Gardens - Sussex Gardens - Sudeley Gardens - Chesterfield Gardens - Cleveland Gardens - Kimberley Gardens - Warwick Gardens

100 Green Lane, Stanhope Gardens, London N4 1AF  
Tel: 020 7794 7771  
www.gra.org.uk



100 Green Lane, Stanhope Gardens, London N4 1AF  
Tel: 020 7794 7771  
www.gra.org.uk

- the prevention of public nuisance.
- the prevention of crime and disorder

In the absence of any information by the applicant on the concept of a Traditional Turkish Café House, we can only assume from experience elsewhere on Green Lanes that it will be yet another social club for men who drink and play cards inside and spend much time smoking and talking outside. This café will not be aimed at local residents.

#### **THE PREVENTION OF PUBLIC NUISANCE: NOISE**

This in itself would not be an issue if the applicant's premises were not located in a residential area, deep inside a private blind alley at the rear of Green Lanes, below residential flats and within 2 meters of the rear windows of a private residential house (*1 Stanhope Gardens*), 7 meters of those at *3 Stanhope Gardens*, 12 meters of *5 Stanhope Gardens*, 17 meters of *7 Stanhope Gardens* with families, including babies, young children and old people.

The location of the premises next door (two meters) to the back door of the outside smoking area of Café Mezzo is also of a great concern as it will be impossible to prevent customers to move from one building to the other even with the best intention or CCTV system, unless both doors are permanently guarded by respective staff, who will of course have conversations and possibly arguments and confrontations as people move from one café to the other.

The noise made by people coming and leaving will be unbearable at any time of the day for the residents across the alley and at night, when the general sound level falls down, for all the residents overlooking the back gardens between Stanhope Gardens and Rutland Gardens and in the flats above the premises at the rear of Green Lanes. This will obviously has a similar impact on nearby residents in Stanhope Gardens as patrons and staff make their way back to Green Lanes or their cars.

#### **THE PREVENTION OF CRIME AND DISORDER: SAFETY**

The alley has a history of loitering, smoking, drinking, eating, drug dealing. It can be threatening for people walking home, especially after dark. The situation has however improved since metal gates were installed and are normally locked from outside after 9pm. Should the licensing application be granted after 9pm, these gates will have to remain open and the situation will inevitably worsen again creating a feeling of danger for residents.

You will be aware that some years ago there was a major problem of crime and disorder on Green Lanes, which had arisen from the Council's *laissez-faire* attitude that let social clubs develop anywhere in the Green Lanes area and

culminate in a fatal shooting in 2002, and that ever since the formation of the Green Lanes Strategy Group eight years ago, local residents and businesses have worked closely together with councillors, council officers and the local police to improve the neighbourhood and have successfully reduced crime and nuisance in this area. We are deeply concerned that if permission is granted for this application, we will lose the gains that have been made, and crime and disorder will once again return to Green Lanes.

We believe the following statements in the Borough's Licensing Policy 2011 support our objections:

*'the Council considers that licensing law plays a key role in both preventing and controlling ... alcohol related crime and anti-social behaviour ... by regulating and applying conditions to affect the number,... location and hours of premises' [2.4]*

*'the council will have special regard to the local impact of licensing on related crime and disorder ... particularly when considering the location, impact, operation and management of all proposed licenses, applications, renewals and variations of conditions' [8.6]*

*'licensed premises, especially those operating late at night and in the early hours of the morning, can cause a wide range of nuisances that can impact on the people living, working or sleeping in the vicinity of the licensed premises. The Council is committed to protecting the residents ... in the vicinity of these licensed premises.'* [14.1]

*'in particular, late night activities cause much of this nuisance. Late night ... restaurants ... can have a number of adverse effects on the residents in the vicinity of these premises. Nuisance such as noise, litter, anti-social behaviour, lights and odour all contribute to the loss of amenity to the general public' [14.2]*

*'noise nuisance is of particular concern ... especially at night when the ambient noise level is low' [14.3]*

*'the conduct of customers leaving premises or spilling out into public and open spaces is often a source of disturbance and anti-social behaviour' [14.4]*

*'the potential for additional crime and disorder and/or public nuisance is increased with longer hours.'* [19.1]

*'when issuing a licence, stricter conditions with regard to noise control and/or limitations to opening hours may be imposed in the case of premises where relevant representations are made and that are situated in largely residential areas. Operating hours between 23.00 and 07.00 are considered to give greater potential for noise nuisance' [19.3]*

We are also aware that the premises have no planning use whatsoever, that they were built without any planning permission in the last two years, that a planning contravention enforcement against the premises has recently been issued, that moreover, Condition 5 of Planning Decision for application HGY/2008/0844 relating to the smoking room at the rear of Café Mezzo, 64 Grand Parade, Green Lanes, states:

***5. The smoking area which is the subject of this permission, is to be access only from the main cafe building [on Green Lanes] and not the alleyway.***

***Reason: In order to protect the amenity of nearby residents.***

making the granting of a future Planning application extremely unlikely for the Applicant's premises, under those circumstances and in view of our objections based on the key Licensing Objectives, the granting of a license to these premises, whatever the time of the day, would be totally inappropriate.

Yours sincerely

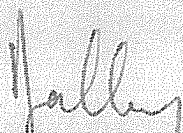

Francois Ballay  
Chair, Gardens Residents Association  
GRA@ballay1.demon.co.uk



Above: 1 Stanhope Gardens from the door of proposed café  
Below: the proposed café with Licensing notice in window, next door: Mezzo smoking area

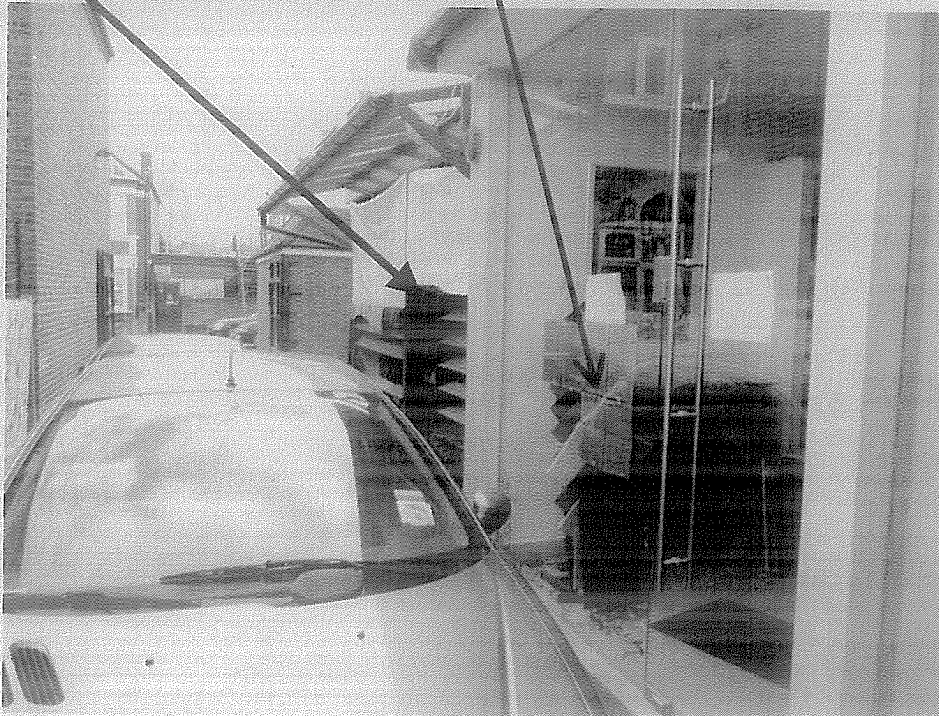

Below: the gates of the alleyway. On the right 1 Stanhope Gardens.



hearing required.

Olson Kendra

---

**From:** Barrett Daliah  
**Sent:** 24 January 2012 17:24  
**To:** Olson Kendra  
**Subject:** Fw: planning application objection  
**Follow Up Flag:** Follow up  
**Flag Status:** Red  
**Attachments:** AE objection -63 Grand Parade.doc

---

**From:** Annette Elder [mailto:annette.elder@elderrahimi.co.uk]  
**Sent:** Tuesday, January 24, 2012 05:13 PM  
**To:** Barrett Daliah  
**Subject:** planning application objection

Dear Ms Barrett

Please find enclosed my objection to the Licensing application in reference

Annette Elder

---

This email has been scanned by the Symantec Email Security.cloud service.  
For more information please visit <http://www.symanteccloud.com>

---

Ms Daliah Barrett  
Lead Licensing Officer  
Haringey Council  
Techno Park  
Ashley Rd  
London N17 9LN

Daliah.Barrett@haringey.gov.uk

RE: PREMISES LICENCE BY TURKISH TRADITIONAL CAFE HOUSE AT  
REAR OF 63 GRAND PARADE, GREEN LANES, N4 1AF.

24 January 2012

Dear Ms Barrett

As the owner and resident of 7 Stanhope Gardens which is very close to the proposed premises, I am writing to object strongly to the application above, which should not be allowed to open at any time of the day or night.

Though my house is close to Green Lanes, it is quiet, especially after dark when ambient noise is low, in particular at the rear where my young child goes to bed as early as 8pm. Any noise happening in the alleyway reverberates across the gardens between Stanhope and Rutland Gardens and will make her nights, and consequently mine, a misery.

I believe that the proposed Turkish café will have a no smoking area, and that patrons will not only make noise on their way in and out but will also stand around for hours chatting, smoking, dropping cigarettes, making the alley and pavement outside the alley dirty, noisy, threatening and unsafe.

Metal gates at the entrance of the alley which are closed after dark most nights, have helped to make the area tidier, quieter and safer. Granting a license until midnight would, I suppose, mean that those gates must remain open until closing time allowing the previous situation to develop again. That is not acceptable.

Regularly I have to work late and coming home alone after dark as a lone female when there are groups of men hanging around on the street feels threatening. This is already the situation often when there are events at the Community Centre in Portland Gardens. If there is a social club up the alleyway,

especially one where alcohol is served, this situation will be permanent.

Stanhope Gardens is a residential street. The opening of a business serving alcohol with an almost exclusively male clientele with the access on Stanhope Gardens is wholly inappropriate and sets an extremely negative precedent. It will be damaging to the community on many levels.

I hope that the application will be unsuccessful.

Yours sincerely

Annette Elder

7 Stanhope Gardens  
London N4 1HY  
annette.elder@gmail.com

## LADDER COMMUNITY SAFETY PARTNERSHIP

PO Box 32109, London N4 1GN

lcsp@blueyonder.co.uk

Ms D Barrett  
Lead Licensing Officer  
Haringey Council  
Techno Park  
Ashley Rd  
London N17 9LN

25 January 2012

Dear Ms Barrett

**New premises licence: Traditional Turkish Coffee House,  
rear of 63 Grand Parade, Green Lanes, N4 1AF  
Applying for late night refreshment & sale of alcohol to 12 midnight (daily)  
closing at 12.30 (daily)**

### 1 INTRODUCTION

The Ladder Community Safety Partnership (LCSP) contains representatives of Neighbourhood Watches and Residents' Associations both from the 'Ladder' roads, and in Green Lanes itself. We are an independent group, although working in partnership with Haringey Council and the Metropolitan Police where appropriate.

We have been contacted by many of our members (especially those who live in proximity to the above premises) who have asked the LCSP to object to this application on their behalf.

**We are therefore writing to you as members of the LCSP to oppose this application.**

**We believe that in the context of a residential area, granting a licence for the activities and hours requested would be against the general principles of Haringey's Licencing Policy and specifically under the following headings:**

- **The Prevention of Crime and Disorder**
- **Prevention of Public Nuisance**

**We are concerned, in particular, at the issues surrounding the prevention of public nuisance, in the light of the specific location of the proposed venue.**

More information on why we believe the Committee should reject this application is provided under appropriate headings below.

## 2. REASONS FOR OBJECTING

### (a) Relevant sections of the Borough's Licensing Policy/Objectives

We believe the following statements in the Borough's Licensing Policy 2011 support our objections:

- *'the Council considers that licensing law plays a key role in both preventing and controlling ... alcohol related crime and anti-social behaviour ... by regulating and applying conditions to affect the number, ... location and hours of premises' [2.4]*
- *'the council will have special regard to the local impact of licensing on related crime and disorder ... particularly when considering the location, impact, operation and management of all proposed licenses, applications, renewals and variations of conditions' [8.6]*
- *'licensed premises, especially those operating late at night and in the early hours of the morning, can cause a wide range of nuisances that can impact on the people living, working or sleeping in the vicinity of the licensed premises. The Council is committed to protecting the residents ... in the vicinity of these licensed premises.' [14.1]*
- *'in particular, late night activities cause much of this nuisance. Late night ... restaurants ... can have a number of adverse effects on the residents in the vicinity of these premises. Nuisance such as noise, litter, anti-social behaviour, lights and odour all contribute to the loss of amenity to the general public' [14.2]*
- *'noise nuisance is of particular concern ... especially at night when the ambient noise level is low' [14.3]*
- *'the conduct of customers leaving premises or spilling out into public and open spaces is often a source of disturbance and anti-social behaviour' [14.4]*
- *'the potential for additional crime and disorder and/or public nuisance is increased with longer hours.' [19.1]*
- *'when issuing a licence, stricter conditions with regard to noise control and/or limitations to opening hours may be imposed in the case of premises where relevant representations are made and that are situated in largely residential areas. Operating hours between 23.00 and 07.00 are considered to give greater potential for noise nuisance' [19.3]*

### (b) Location and Licensing Hours

A key issue with regard to the application is the location of the premises. It is not in Green Lanes, but rather at the far end of an access/service passage which runs behind the first few commercial premises in the particular block. There is no other entry or exit as the passage is a dead-end. The proposed venue is directly adjacent to residential properties in Stanhope Gardens, and only a few feet from the rear windows of 1 Stanhope Gardens. It is also directly beneath the rear windows (often bedrooms) of numerous flats in Grand Parade, Green Lanes. It is therefore a totally inappropriate location for any licensed premises, at any time.

**(c) The Prevention of Crime and Disorder and Prevention of Public Nuisance**

The passageway has a well-known history of anti-social behaviour including loitering (with sexual intent) and drug-dealing, which has to some extent been alleviated by the installation of sturdy metal gates, locked by a padlock every evening. They are certainly shut long before the proposed closing time (12.30am daily) of the new venue, and would presumably have to be kept open until about 1am daily to allow the final customers, and staff, to depart. This would obviously recreate all the problems which the installation of the gates was designed to prevent.

This is not speculation, but based on knowledge of past experience. Members of the Licensing Committee will no doubt recall, as we do, what happened to Green Lanes when a late-night culture took over in the early 2000s. Green Lanes became, frankly, a dirty, dangerous and unpleasant place to be, culminating in the violent and fatal incident of 2002. Since then, residents, traders police and council offers, and local Councillors have all worked together in the Green Lanes Strategy Group to make Green Lanes the safer, quieter, cleaner - in short, better - place which it is today. We are therefore very anxious not to repeat the same mistake by moving back, which is where granting this application will take us.

**(d) Prevention of Public Nuisance**

This is obviously linked to the concerns noted above. In particular, there is likely to be real problem with noise nuisance at any time of the day or night. This will be at its worst late in the evening and through to at least 12.30am daily, with customers and staff having to walk along the passage to exit into Stanhope Gardens. Any customers wishing to smoke will also be forced to congregate in the passageway as there is nowhere else to go. Late at night, when ambient noise levels are low, this will have a serious and negative impact on numerous residents in Stanhope and Rutland Gardens and the flats along this section of Grand Parade, Green Lanes.

**(e) Planning Issues**

**We are very aware that planning and licensing are two separate regimes. However it is worth noting here that the premises do not have planning permission and that LBH Enforcement have already issued a PCN. Approval for A3 use, in this location, is totally implausible, the more so given that the adjacent premises (64 Grand Parade, Café Mezzo) has a smoking area which is to be accessed '*only from the main café building and not from the alleyway*'. The reason is to protect the amenity of nearby residents. (HGY/2008/0844)**

**3. CONCLUSION**

Our comments and objections, clearly based on the key objectives and appropriate paragraphs of the borough's Licensing Policy (noted above), make clear that residents are extremely worried at the likely implications for the immediate, and the broader, local area, if this application were to be granted.

We do not believe that any conditions could be imposed which would mitigate this, and so we strongly urge the Licensing Committee to refuse to grant permission for a licence to this premises, whatever the time of day.

Yours sincerely

Chair, LCSP

**Olson Kendra**

---

**From:** Barrett Daliah  
**Sent:** 27 January 2012 00:13  
**To:** Olson Kendra  
**Subject:** Fw: Premises licence by Turkish Traditional Cafe House at rear of 63 Grand Parade

---

**From:** Phillip Kennedy [mailto:kennedy.phil@gmail.com]  
**Sent:** Thursday, January 26, 2012 11:39 PM  
**To:** Barrett Daliah  
**Subject:** Re: Premises licence by Turkish Traditional Cafe House at rear of 63 Grand Parade

Ms Daliah Barrett  
Lead Licensing Officer  
Haringey Council  
Techno Park  
Ashley Rd  
London N17 9LN

Daliah.Barrett@haringey.gov.uk

Re: Premises licence by Turkish Traditional Cafe House at rear of 63  
Grand Parade, Green Lanes, N4 1AF.

26 January 2012

Dear Ms Barrett

I am the owner of No. 5 Stanhope Gardens and would like to object to the application for a license for 63 Grand Parade.

The glaring inconsistency of a property with no appropriate planning history or permissioning being able to apply for licensing aside, I believe the granting of the application would be counter to the policies the council has set out. In particular, those relating to noise nuisance, the protection of young children, and the the safety of the general public.

The property in the application is surrounded by residential properties which would be adversely impacted by the noise generated in the evening. As yet we have seen little detail as to the functioning of the premise. We are left to assume that access would only be available via the gated access to the rear of the property.

This area has historically been a cause of concern for both residents in the immediate proximity and for any of the borough's residents using Stanhope Gardens as a thoroughfare. The access has proven to be a threatening and intimidating space for local residents given the types of individuals who already frequent the poorly lit and secluded area.

With a small child in our property, we are also very concerned about the levels of noise that can echo throughout the terraced homes' gardens in the area. Noise from the property in the application would certainly cause significant disturbance given its position at the head of the rear gardens of homes in Stanhope and Rutland Gardens. The increased late-night traffic to and from the property would also add to the inconvenience faced by residents as patrons enter and leave licensed premises.

It remains rather depressing that after the difficulties the area has faced in recent years, a clear message has not been received by those proprietors wishing to blindside the planning and licensing processes.

And so, I trust that the refusal of this application will help to reinforce the positive steps the borough has made to remedy this kind of behaviour.

Yours sincerely

Phil Kennedy

5 Stanhope Gardens  
London N4 1HY

---

This email has been scanned by the Symantec Email Security.cloud service.  
For more information please visit <http://www.symanteccloud.com>

---

This page is intentionally left blank

**Olson Kendra**

---

**From:** Barrett Daliah  
**Sent:** 27 January 2012 11:51  
**To:** 'Ozlem Ozcan [ Licensing ]'  
**Cc:** Shah Noshaba; Olson Kendra  
**Subject:** FW: Objection to application for license for 63 Green Lanes N4 1AF

For your action.  
Regards  
Daliah Barrett

---

**From:** Julia Bell [mailto:juliabell\_697@hotmail.com]  
**Sent:** 27 January 2012 11:39  
**To:** Barrett Daliah  
**Subject:** Objection to application for license for 63 Green Lanes N4 1AF

Hello

I wish to object to the licensing application for the provision of late night refreshment and the supply of alcohol at 63 Green Lanes N4 1AF.

This proposal is wrong on many grounds. First, being stuck up an alley, I doubt it is designed for the local residents but is an excuse to open up another 'social club' that would involve much loitering, smoking and talking outside.

Second, it is in a residential alley, close to homes. The noise of people socializing and coming and going would obviously be a nuisance.

Thirdly, why was that building erected there in the first place? Is it legal?

Regards Julia Bell  
12 Rutland Gardens  
London N41JP

---

This email has been scanned by the Symantec Email Security.cloud service.  
For more information please visit <http://www.symanteccloud.com>

---

**Olson Kendra**

---

**From:** Barrett Daliah  
**Sent:** 28 January 2012 21:28  
**To:** Olson Kendra  
**Subject:** Fw: 63 Green LANes

---

**From:** Cllr Brabazon Zena  
**Sent:** Saturday, January 28, 2012 07:06 PM  
**To:** Barrett Daliah  
**Subject:** FW: 63 Green LANes

---

Dear Ms Barrett

Please accept this email as my formal representation with regard to the request for a new premises licence for a Traditional Turkish Coffee House, rear of 63 Grand Parade, Green Lanes, N4 1AF. As you know the application is for late night refreshment & sale of alcohol to 12 midnight (daily), closing at 12.30am (daily)

This premises is in my ward (St. Ann's) and I have very serious concerns about it which are set out below.

This is a residential area and I believe there are particular issues with this application related to the prevention of public nuisance and prevention of crime and disorder in relation to this specific location. These are key elements of the Council's Licensing policy.

In relation to this application it would appear local objections are in tune with the Borough's Licensing Policy 2011, especially those bullet points below:

*'the Council considers that licensing law plays a key role in both preventing and controlling ... alcohol related crime and anti-social behaviour ... by regulating and applying conditions to affect the number, ... location and hours of premises' [2.4]*

- *'the council will have special regard to the local impact of licensing on related crime and disorder ... particularly when considering the location, impact, operation and management of all proposed licenses, applications, renewals and variations of conditions' [8.6]*
- *'licensed premises, especially those operating late at night and in the early hours of the morning, can cause a wide range of nuisances that can impact on the people living, working or sleeping in the vicinity of the licensed premises. The Council is committed to protecting the residents ... in the vicinity of these licensed premises.' [14.1]*
- *'in particular, late night activities cause much of this nuisance. Late night ... restaurants ... can have a number of adverse effects on the residents in the vicinity of these premises. Nuisance such as noise, litter, anti-social behaviour, lights and odour all contribute to the loss of amenity to the general public' [14.2]*
- *'noise nuisance is of particular concern ... especially at night when the ambient noise level is low' [14.3]*
- *'the conduct of customers leaving premises or spilling out into public and open spaces is*

*often a source of disturbance and anti-social behaviour' [14.4]*

- *'the potential for additional crime and disorder and/or public nuisance is increased with longer hours.' [19.1]*
- *'when issuing a licence, stricter conditions with regard to noise control and/or limitations to opening hours may be imposed in the case of premises where relevant representations are made and that are situated in largely residential areas. Operating hours between 23.00 and 07.00 are considered to give greater potential for noise nuisance' [19.3]*

Location of these premises is a key issue. It is not in Green Lanes, but rather at the far end of an access/service passage which runs behind the first few commercial premises in the particular block. There is no other entry or exit as the passage is a dead-end. The proposed venue is directly adjacent to residential properties in Stanhope Gardens, and only a few feet from the rear windows of 1 Stanhope Gardens. It is also directly beneath the rear windows (often bedrooms) of numerous flats in Grand Parade, Green Lanes. I would suggest therefore that it is a totally inappropriate location for any licensed premises, at any time as spelled out in more detail below where the points refer to the Council's licensing objectives.

#### **Prevention of Crime and Disorder and Prevention of Public Nuisance**

The passageway has a well-known history of anti-social behaviour including loitering (with sexual intent) and drug-dealing, which has to some extent been alleviated by the installation of sturdy metal gates, locked by a padlock every evening. These are certainly shut long before the proposed closing time of the new venue (12.30am daily), and would presumably have to be kept open until about 1am daily to allow the final customers, and staff, to depart. This would obviously recreate all the problems which the installation of the gates was designed to prevent and goes entirely against the rationale for installing the gates in the first place. It would undo many years of effort to improve the area for local residents.

This is not speculation, but based on knowledge of past experience as set out by the Ladder Community Safety Partnership in their submission. Over 10 years, since the terrible incident of 2002, residents, traders police, council officers and local Councillors have all worked together in the Green Lanes Strategy Group to make Green Lanes the safer, quieter, cleaner - in short, better - place which it is today.

Like local residents and community groups I am very anxious that the Council as Licensing Authority does not repeat the same mistake by moving back, which is where granting this application will take us.

#### **Prevention of Public Nuisance**

This is obviously linked to the concerns noted above. In particular, there is likely to be real problem with noise nuisance at any time of the day or night. This will be at its worst late in the evening and through to at least 12.30am daily, with customers and staff having to walk along the passage to exit into Stanhope Gardens. Any customers wishing to smoke will also be forced to congregate in the passageway as there is nowhere else to go. Late at night, when ambient noise levels are low, this will have a serious and negative impact on numerous residents in Stanhope and Rutland Gardens and the flats along this section of Grand Parade, Green Lanes.

#### **Planning Issues**

I am entirely aware that planning and licensing are two separate regimes. However it is important that the committee notes that these premises do not have planning permission. I have been in touch with Planning Enforcement and they have already issued a Planning

**Contravention Notice.** Approval for A3 use, in this location, is totally implausible, the more so given that the adjacent premises (64 Grand Parade, Café Mezzo) has a smoking area which is to be accessed '*only from the main café building and not from the alleyway*'. The reason is to protect the amenity of nearby residents. (HGY/2008/0844) Allowing this application would contradict this since the coffee house would be operating in the alleyway!

## CONCLUSION

The comments and objections above are based on the key objectives and appropriate paragraphs of the borough's Licensing Policy and the committee is asked to take these very seriously in its deliberations. Along with local residents I am extremely worried at the likely implications for the immediate, and the broader, local area, if this application were to be granted.

I share the view of local residents that there are no conditions which could mitigate this and ask you to take the step of refusing to grant permission for a licence to this premises, whatever the time of day.

Yours sincerely

Zena Brabazon  
Cllr St. Ann's Ward

---

email: [zena.brabazon@haringey.gov.uk](mailto:zena.brabazon@haringey.gov.uk)

Tel: 0208 216 9151  
Mob: 07854 002 318

**Olson Kendra**

---

**From:** Barrett Daliah  
**Sent:** 28 January 2012 12:21  
**To:** Olson Kendra; Shah Noshaba  
**Subject:** Fw: 63 Grand Parade,Green Lanes, N4 1AF

---

**From:** Cllr Alexander Karen  
**Sent:** Saturday, January 28, 2012 12:19 PM  
**To:** Barrett Daliah  
**Subject:** 63 Grand Parade,Green Lanes, N4 1AF

**New premises licence: Traditional Turkish Coffee House,  
rear of 63 Grand Parade,Green Lanes, N4 1AF  
Applying for late night refreshment & sale of alcohol to 12 midnight (daily)  
closing at 12.30 (daily)**

Dear Ms Barrett

I refer to the above premise and their application for a licence. I have been copied in to the objection letter from the Ladder Community Partnership and I would like to lodge my own objection to the granting of a licence for all the reasons set out in their (LCSP) letter of 25th January 2012.

Granting of the licence would be whole inappropriate as the premises is in a residential area and not on Green Lanes and there is a danger that this would set a precedent.

I would urge you **not** to grant the licence to this premises.

Yours sincerely

**Karen Alexander**

*Liberal Democrat Councillor for Harringay Ward*  
[karen.alexander2@haringey.gov.uk](mailto:karen.alexander2@haringey.gov.uk)  
020 8348 3892 / 07875 490055

DATA PROTECTION Whilst our councillor will treat as confidential any personal information which you pass on, s/he will allow authorised staff to see the information if this is needed to help and advise you and may pass all or some of this information to agencies such as the DSS, Inland Revenue or the local council if this is necessary to help your case. S/he may wish to write to you from time to time to keep you informed on related issues that you may find of interest. Please let him/her know if you do not wish to be contacted in this way. Karen Alexander Liberal Democrat Councillor for Harringay Ward [karen.alexander2@haringey.gov.uk](mailto:karen.alexander2@haringey.gov.uk) <<mailto:karen.alexander2@haringey.gov.uk>> 020 8348 3892 / 07875 490055

1 Stanhope Gardens,  
Harringay,  
London N4 1HY  
8th February 2012

Ms Daliah Barrett  
Lead Licensing Officer  
Haringey Council  
Techno Park  
Ashley Road ,  
London N17 9LN  
Dear Deliah Barrett,

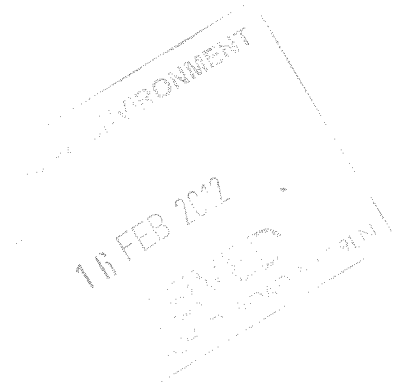

RE: Application for Premises licence by Turkish traditional café house at rear of 63 Grand Parade, Green Lanes N4 1AF. Applying for supply of alcohol 11AM to Midnight (daily) and late night refreshments 11PM to Midnight (daily).

We are writing to you as joint owners of Number 1 Stanhope Gardens to strongly object to the licensing application for the provision of late night refreshments and for the supply of alcohol at rear of 63 Green Lanes N4 1AF.

The Applicants premises at rear of 63 Green Lanes is situated in an alley approximately 2-3 metres from the side and back windows of our property at 1 Stanhope Gardens and is in a densely populated residential area.

We **STRONGLY** object to this proposal as we believe that the premises is unsuitable for an alcoholic licence and for late night trading.

We believe that if permission was granted it would have a serious detrimental effect on the residents of 1 Stanhope Gardens and all other residents in the vicinity.

We believe that to grant a licence as requested above in a densely residential area would be contrary to Haringey's licensing objectives under the following headings:-

**Prevention Of Public Nuisance (Noise)**

The noise made by people entering and leaving the premises will be unbearable at any time of the day for the residents of 1 Stanhope Gardens and it will get worse at night when general sound levels fall and it will also have a severe detrimental effect on other local residents.

**Prevention Of Crime and Disorder (Safety)**

The alley has had major problems of loitering, drinking, smoking, urinating etc in the past but it has improved since metal gates were installed for security reasons, as they are locked after 9PM daily. Should the licensing application be granted, then the gates will have to remain open after 9PM and the situation will revert to what it was before, creating a feeling of fear and insecurity for local residents.

We consider that due to our objections based on haringey's own licensing objectives, the granting of a licence for these premises would be totally inappropriate.

Yours sincerely,

AM and JB Coffey.

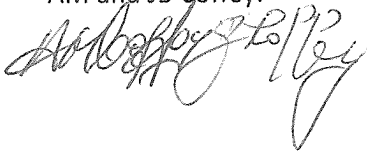
A handwritten signature in black ink, appearing to read 'AM and JB Coffey', written in a cursive style.

Mr Suleyman Aksoy  
Mezzo Bar and Restaurant  
64 Grand Parade  
Green Lanes  
London N4 1AF  
Tel: 020 8800 8996

Licensing Team  
Commercial Services  
Urban Environment  
Units 271-272 Lee Valley Technopark  
Ashley Road  
Tottenham  
N17 9LN



Date: 3<sup>rd</sup> January 2012

Dear Sirs,

**RE: Objection to an application for a Premises Licence at Rear of 63 Grand Parade, Green Lanes, London N4 1AF**

I am writing to inform you of my objections to the granting of a premises licence for the above stated premises.

I am the owner of a business in front of the premises of the above stated application. My business address is Mezzo Bar and Restaurant, 64 Grand Parade, Green Lanes, London N4 1AF. I object to the application on the following grounds:

1. The notice of the application has been placed in the window of the premises which cannot be seen by anyone as there is no public footfall there. It is in a closed area and no one has any reason to go into that area in order to become aware of the notice. We would therefore require notice of this application to be placed some other place of the building where it can be seen by the local; residents and businesses;
2. The premises are unsuitable for the intended use as there is only rear access to the premises. The said access is there as a fire escape only and should not be used to gain access to the premises;
3. The alleyway leading to the said premises is closed at night for security reasons to prevent unsocial activities from taking place, i.e. use of drugs, and prevention of burglaries, prevention of prostitution;

4. The said premises are close to residential premises and will have a negative impact on the noise levels they will have to otherwise endure;
5. I understand the said premises will be turned into a Traditional Turkish Coffee House. These places are known for being gambling dens that are unlicensed and unregulated. The norm of such places is that gambling will take place in secret back rooms all night long. The effect of this is, not only an increase in local crime and gang related incidents, but also the tone of the local area will be reduced.

I trust that my objections will be considered and accordingly trust that the council will make the right decision in refusing this application.

Please do not hesitate to contact me should you require any further information regarding this matter.

Yours faithfully,



Suleyman Aksoy

This page is intentionally left blank